

Doddridge County Sheriff
Flood Plain Ordinance Fund

1042

69-217/515

DATE August 8, 2013

PAY TO THE
ORDER OF

CAROLYN JONES

\$ 4.75

Four Dollars and 75/100

DOLLARS

Security features
included.
Details on back



Ralph Sanderson
Beth A. Rogers
[Signature] MP

MEMO #13-035 Reimburse Bldg. Permit

⑈001042⑈ ⑆051502175⑆

⑆119649⑈

By: BH - MEH - AML
Asst. Chief Tax Deputy

W. C .Underwood Jr.
Sheriff of Doddridge County

The Person paying Money into the Treasury shall forthwith file one of these Receipts with the County Clerk

Doddridge County, West Virginia

No. 99

Date: July 17, 2013
Customer copy

Received: #13-035 Carolyn Jones

\$5.00

In Payment For: 318 Building Permits (LP)

For: 12-Flood Plain Ordinance #20 Fund

By: BH - MEH - AML
Asst. Chief Tax Deputy

W. C .Underwood Jr.
Sheriff of Doddridge County

DODDRIDGE COUNTY FLOODPLAIN DEVELOPMENT PERMIT APPLICATION

SECTION 1: GENERAL PROVISIONS (APPLICANT TO READ AND SIGN)

1. No work may start until a permit is issued.
2. The permit may be revoked if any false statements are made herein.
3. If revoked, all work must cease until permit is re-issued.
4. Development shall not be used or occupied until a Certificate of Compliance issued.
5. The permit will expire if no work is commenced within six months of issuance.
6. Applicant is hereby informed that other permits may be required to fulfill local, state, and federal requirements.
7. Applicant hereby gives consent to the Floodplain Administrator/Manager or his/her representative to make inspections to verify compliance.
8. **I, THE APPLICANT CERTIFY THAT ALL STATEMENTS HEREIN AND IN ATTACHMENTS TO THIS APPLICATION ARE, TO THE BEST OF MY KNOWLEDGE, TRUE AND ACCURATE.**

2013 JUL 17 AM 5:02
 PERMIT
 RECEIVED

APPLICANT'S SIGNATURE Carolyn Jones

DATE 7/17/13

SECTION 2: PROPOSE DEVELOPMENT (TO BE COMPLETED BY APPLICANT).

IF THE APPLICANT IS NOT A NATURAL PERSON, THE NAME, ADDRESS, AND TELEPHONE NUMBER OF A NATURAL PERSON WHO SHALL BE APPOINTED BY THE APPLICANT TO RECEIVE NOTICE PURSUANT TO ANY PROVISION OF THE CURRENT DODDRIDGE COUNTY FLOODPLAIN ORDINANCE.

APPLICANT'S NAME: Carolyn Jones

ADDRESS: 2950 WV Route 18 South, West Union, WV

TELEPHONE NUMBER: 304-873-1501

BUILDER'S NAME: Taylor Enterprise Custom Buildings & Carpets
ADDRESS: 613 Maple Ave Philippi, WV 26416
TELEPHONE NUMBER: 304-457-3259

ENGINEER'S NAME: _____
ADDRESS: _____
TELEPHONE NUMBER: _____

PROJECT LOCATION:

NAME OF SURFACE OWNER/OWNERS (IF NOT THE APPLICANT) Anita Jblene Jones

ADDRESS OF SURFACE OWNER/OWNERS (IF NOT THE APPLICANT) _____
2631 WV Rt 18 South, West Union, WV 26456

DISTRICT: New Milton

DATE/FROM WHOM PROPERTY

PURCHASED: _____

LAND BOOK DESCRIPTION: Meathouse Fk 141.5 Ac.

DEED BOOK REFERENCE: _____

TAX MAP REFERENCE: 1 0006 0000 0000

EXISTING BUILDINGS/USES OF PROPERTY: _____

NAME OF AT LEAST ONE ADULT RESIDING IN EACH RESIDENCE LOCATED UPON THE SUBJECT PROPERTY _____

ADDRESS OF AT LEAST ONE ADULT RESIDING IN EACH RESIDENCE LOCATED UPON THE SUBJECT PROPERTY _____

To avoid delay in processing the application, please provide enough information to easily identify the project location.

DESCRIPTION OF WORK (CHECK ALL APPLICABLE BOXES)

A. STRUCTURAL DEVELOPMENT

ACTIVITY

STRUCTURAL TYPE

- | | |
|---|---|
| <input checked="" type="checkbox"/> New Structure | <input type="checkbox"/> Residential (1 – 4 Family) |
| <input type="checkbox"/> Addition | <input type="checkbox"/> Residential (more than 4 Family) |
| <input type="checkbox"/> Alteration | <input type="checkbox"/> Non-residential (floodproofing) |
| <input type="checkbox"/> Relocation | <input type="checkbox"/> Combined Use (res. & com.) |
| <input type="checkbox"/> Demolition | <input type="checkbox"/> Replacement |
| <input type="checkbox"/> Manufactured/Mobil Home | |

B. OTHER DEVELOPMENT ACTIVITIES:

- Fill Mining Drilling Pipelining
 - Grading
 - Excavation (except for STRUCTURAL DEVELOPMENT checked above)
 - Watercourse Alteration (including dredging and channel modification)
 - Drainage Improvements (including culvert work)
 - Road, Street, or Bridge Construction
 - Subdivision (including new expansion)
 - Individual Water or Sewer System
 - Other (please specify)
-

C. STANDARD SITE PLAN OR SKETCH

1. SUBMIT ALL STANDARD SITE PLANS, IF ANY HAVE BEEN PREPARED.
2. IF STANDARD SITE PLANS HAVE NOT BEEN PREPARED:
SKETCH ON A SEPARATE 8 ½ X 11 INCH SHEET OF PAPER THE SHAPE AND LOCATION OF THE LOT. SHOW THE LOCATION OF THE INTENDED CONSTRUCTION OR LAND USE INDICATING BUILDING SETBACKS, SIZE & HEIGHT. IDENTIFY EXISTING BUILDINGS, STRUCTURES OR LAND USES ON THE PROPERTY.
3. SIGN AND DATE THE SKETCH.

ACTUAL TOTAL CONSTRUCTION COSTS OF THE COMPLETE DEVELOPMENT IRRESPECTIVE OF WHETHER ALL OR ANY PART OF THE SUBJECT PROPOSED CONSTRUCTION PROJECT IS WITHIN THE FLOODPLAIN \$ 10,000

D. ADJACENT AND/OR AFFECTED LANDOWNERS:

1. NAME AND ADDRESS OF ALL OWNERS OF SURFACE TRACTS ADJACENT TO THE AREA OF THE SURFACE TRACT (UP & DOWN STREAM) UPON WHICH THE PROPOSED ACTIVITY WILL OCCUR AND ALL OTHER SURFACE OWNERS UP & DOWN STREAM) WHO OWN PROPERTY THAT MAY BE AFFECTED BY FLOODING AS IS DEMONSTRATED BY A FLOODPLAIN STUDY OR SURVEY (IF ONE HAS BEEN COMPLETED).

NAME: _____
ADDRESS: _____

NAME: _____
ADDRESS: _____

NAME: _____
ADDRESS: _____

NAME: _____
ADDRESS: _____

1. NAME AND ADDRESS OF AT LEAST ONE ADULT RESIDING IN EACH RESIDENCE LOCATED UPON ANY ADJACENT PROPERTY AT THE TIME THE FLOODPLAIN PERMIT APPLICATION IS FILED AND THE NAME AND ADDRESS OF AT LEAST ONE ADULT RESIDING IN ANY HOME ON ANY PROPERTY THAT MAY BE AFFECTED BY FLOODING AS IS DEMONSTRATED BY A FLOODPLAIN STUDY OR SURVEY.

NAME: _____
ADDRESS: _____

NAME: _____
ADDRESS: _____

NAME: _____
ADDRESS: _____

NAME: _____
ADDRESS: _____

E. CONFIRMATION FORM

THE APPLICANT ACKNOWLEDGES, AGREES, AND CONFIRMS THAT HE/IT WILL PAY WITHIN 30 DAYS OF RECEIPT OF INVOICE BY THE COUNTY FOR ALL EXPENSES RELATIVE TO THE PERMIT APPLICATION PROCESS GREATER THAN THE REQUIRED DEPOSIT FOR EXPENSES INCLUDING:

- (A) PERSONAL SERVICE OF PROCESS BY THE DODDRIDGE COUNTY SHERIFF AT THE RATES PERMITTED BY LAW FOR SUCH SERVICE.
- (B) SERVICE BY CERTIFIED MAIL RETURN RECEIPT REQUESTED.
- (C) PUBLICATION.

- (D) COURT REPORTING SERVICES AT ANY HEARINGS REQUESTED BY THE APPLICANT.
- (E) CONSULTANTS AND/OR HEARING EXPERTS UTILIZED BY DODDRIDGE COUNTY FLOODPLAIN ADMINISTRATOR/MANAGER OR FLOODPLAIN APPEALS BOARD FOR REVIEW OF MATERIALS AND/OR TESTIMONY REGARDING THE EFFICACY OF GRANTING OR DENYING THE APPLICANT'S FLOODPLAIN PERMIT.

NAME (PRINT): Carolyn Jones

SIGNATURE: Carolyn Jones DATE: 7/17/13

After completing SECTION 2, APPLICANT should submit form to Floodplain Administrator/Manager or his/her representative for review.

SECTION 3: FLOODPLAIN DETERMINATION (to be completed by Floodplain Administrator/Manager or his/her representative)

THE PROPOSED DEVELOPMENT:

THE PROPOSED DEVELOPMENT IS LOCATED ON:

FIRM Panel: 140
 Dated: 10/04/2011

Is **NOT** located in a Specific Flood Hazard Area (Notify applicant that the application review is complete and **NO FLOODPLAIN DEVELOPMENT PERMIT IS REQUIRED**).

Is located in Special Flood Hazard Area.

FIRM zone designation _____
 100-Year flood elevation is: _____ NGVD (MSL)

Unavailable

The proposed development is located in a floodway.

FBFM Panel No. _____ Dated _____

See section 4 for additional instructions.

SIGNED

Don Wellings

DATE

07/17/2013

SECTION 4: ADDITIONAL INFORMATION REQUIRED (To be completed by Floodplain Administrator/Manager or his/her representative)

The applicant must submit the documents checked below before the application can be processed.

- A plan showing the location of all existing structures, water bodies, adjacent roads, lot dimensions and proposed development.
- Development plans, drawn to scale, and specifications, including where applicable: details for anchoring structures, storage tanks, proposed elevation of lowest floor, (including basement or crawl space), types of water resistant materials used below the first floor, details of flood proffing of utilities located below the first floor and details of enclosures below the first floor. Also _____

- Subdivision or other development plans (If the subdivision or development exceeds 50 lots or 5 acres, whichever is the lesser, the applicant must provide 100-year flood elevations if they are not otherwise available).
- Plans showing the extent of watercourse relocation and/or landform alterations..
- Top of new fill elevation _____ Ft. NGVD (MSL).
For floodproofing structures applicant must attach certification from registered engineer or architect.
- Certification from a registered engineer that the proposed activity in a regulatory floodway will not result in any increase in the height of the 100-year flood. A copy of all data and calculations supporting this finding must also be submitted.
- Manufactured homes located in a floodplain area must have a West Virginia Contractor's License and a Manufactured Home Installation License as required by the Federal Emergency Management Agency (FEMA).

Other:

SECTION 5: PERMIT DETERMINATION (To be completed by Floodplain Administrator/Manager or his/her representative)

I have determined that the proposed activity (**type is or is not**) in conformance with provisions of the Floodplain Ordinance adopted by the County Commission of Doddridge County on May 21, 2013. The permit is issued subject to the conditions attached to and made part of this permit.

SIGNED _____ DATE _____

If the Floodplain Administrator/Manager found that the above was not in conformance with the provisions of the Doddridge County Floodplain Ordinance and/or denied that application, the applicant may complete an appealing process below.

APPEALS: Appealed to the County Commission of Doddridge County? Yes No

Hearing Date: _____

County Commission Decision - Approved Yes No

CONDITIONS: _____

SECTION 6: AS-BUILT ELEVATIONS (To be submitted by APPLICANT before Certificate of Compliance is issued).

The following information must be provided for project structures. This section must be completed by a registered professional engineer or a licensed land surveyor (or attach a certification to this application).

Road 18 south

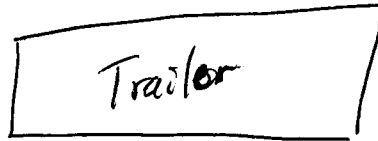

Trailer

already on
property

Propose
Tank

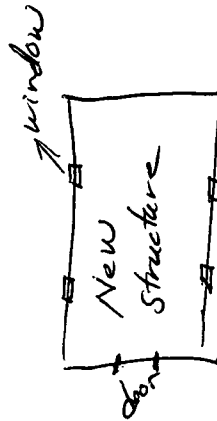

14' X 32'

pre made

building

COMPLETE 1 OR 2 BELOW:

- 1 Actual (As-Built) Elevation of the top of the lowest floor (including basement or crawl space is _____ FT. NGVD (MSL)
- 2 Actual (As Built) elevation of floodproofing is _____ FT. NGVD (MSL)

Note: Any work performed prior to submittal of the above information is at risk of the applicant.

SECTION 7: COMPLIANCE ACTION (To be completed by the Floodplain Administrator/Manager or his/her representative).

The Floodplain Administrator/Manager or his/her representative will complete this section as applicable based on inspection of the project to ensure compliance with the Doddridge County Floodplain Ordinance.

INSPECTIONS:

DATE: _____ BY: _____
DEFICIENCIES ? Y/N

COMMENTS _____

SECTION 8: CERTIFICATE OF COMPLIANCE (To be completed by Floodplain Administrator/Manager or his/her representative).

Certificate of Compliance issued: DATE: _____ BY: _____

**CERTIFICATE OF COMPLIANCE
FOR DEVELOPMENT IN SPECIAL FLOOD HAZARD AREA
(OWNER MUST RETAIN)**

PERMIT NUMBER: _____

PERMIT DATE: _____

PURPOSE –

CONSTRUCTION LOCATION: _____

OWNER'S ADDRESS: _____

**THE FOLLOWING MUST BE COMPLETED BY THE FLOODPLAIN
ADMINISTRATOR/MANAGER OR HIS/HER AGENT.**

**COMPLIANCE IS HEREBY CERTIFIED WITH THE REQUIREMENT OF THE
FLOODPLAIN ORDINANCE ADOPTED BY THE COUNTY COMMISSION OF
DODDRIDGE COUNTY ON MAY 21, 2013.**

SIGNED _____ DATE _____

previous F
ferred from
ew stream
dway Dat
hich contai
hat differ fro

1 this map a
hanges due
was publish
/ current cor

rately printe
t of map pa
ities table d
as well as a

ble product
website at
.etters of M
this map.
ISC website

out this m
in general
:77-FEMA-N
gov/busines

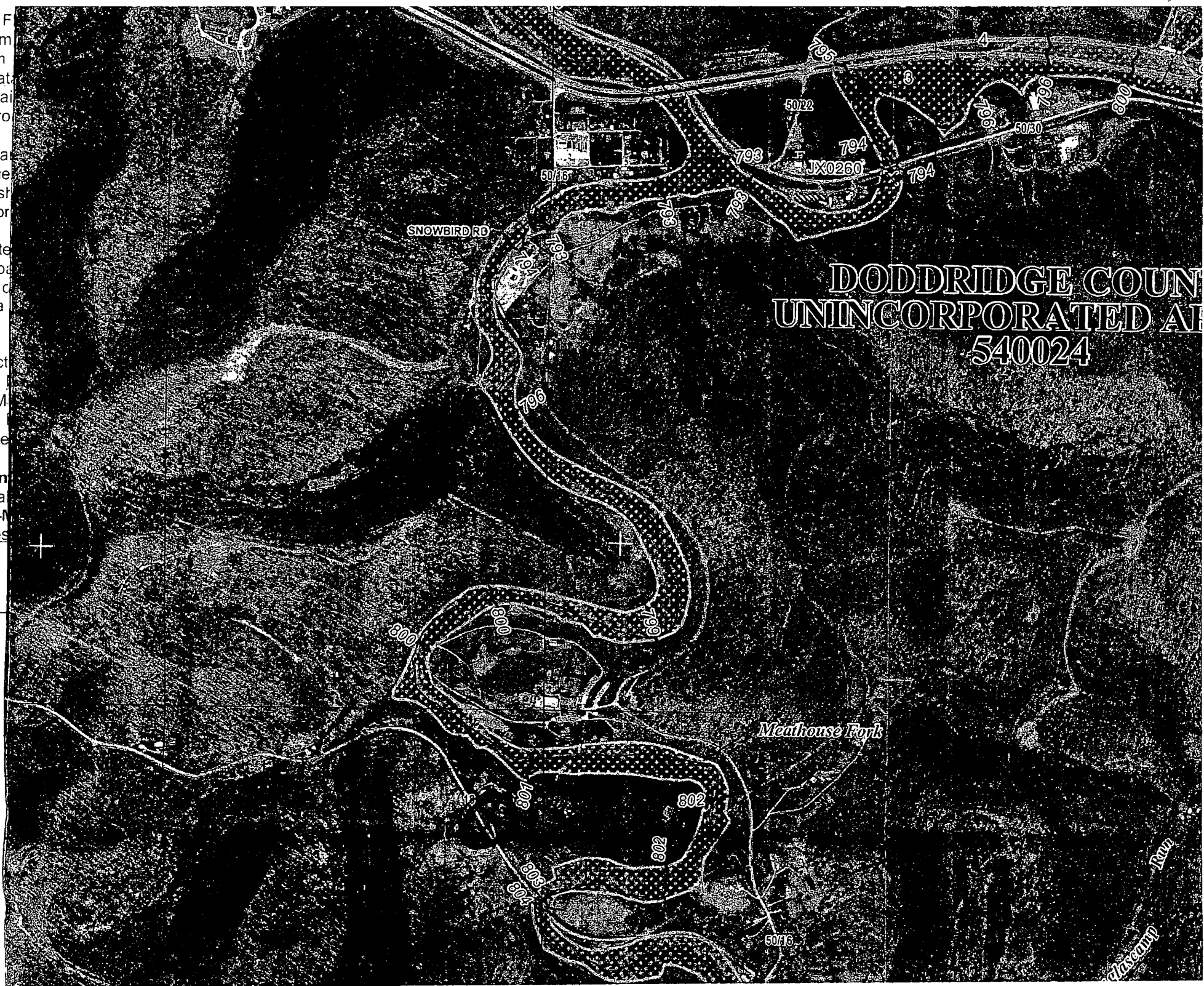

DODDRIDGE COUNTY
UNINCORPORATED AREA
540024

Panel 140

NOT IN FLOODPLAIN