

**CERTIFIED MAIL™**

Doddridge County FPM  
118 East Court ST STE 102  
West Union, WV 26456-1262

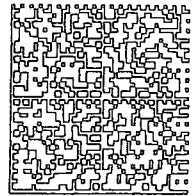

7013 2250 0001 6914 9053



HASLER	015H14161808
	<b>\$6.48</b>
	08/08/14
Mailed From 26456	

US POSTAGE

8/21/14  
3649 DB

- MOVED
- FOR
- AT
- UNDELIVERABLE
- NO
- NO
- INSUFFICIENT

- A
- C
- S
- INSUFFICIENT ADDRESS
- ATTEMPTED NOT KNOWN
- NO SUCH NUMBER/ STREET
- NOT DELIVERABLE AS ADDRESSED - UNABLE TO FORWARD
- OTHER

**RTS**  
RETURN TO SENDER

IN A ROBERT  
LUNNY CLE  
DODDRIDGE COUNTY

2014 SEP -2 AM 11:57

11/1/14

2642689610 R001

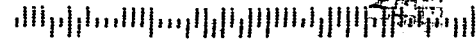

PLACE STICKER AT TOP OF ENVELOPE TO THE RIGHT  
OF THE RETURN ADDRESS. FOLD AT DOTTED LINE

**SENDER: COMPLETE THIS SECTION**

- Complete items 1, 2, and 3. Also complete item 4 if Restricted Delivery is desired.
- Print your name and address on the reverse so that we can return the card to you.
- Attach this card to the back of the mailpiece, or on the front if space permits.

1. Article Addressed to:

#14-247  
Richard Keith Jozwick  
Rt 1 Box 394  
Salem, WV 26426

2. Article Number  
(Transfer from service label)

7013 2250 0001 6914 9053

PS Form 3811, July 2013

Domestic Return Receipt

**COMPLETE THIS SECTION ON DELIVERY**

A. Signature

X

- Agent  
 Addressee

B. Received by (Printed Name)

C. Date of Delivery

D. Is delivery address different from item 1?  Yes  
If YES, enter delivery address below:  No

3. Service Type

- Certified Mail®  Priority Mail Express™  
 Registered  Return Receipt for Merchandise  
 Insured Mail  Collect on Delivery

4. Restricted Delivery? (Extra Fee)  Yes

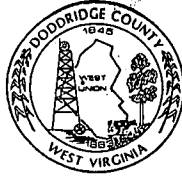

Doddridge County FPM  
118 East Court Street, Suite 102  
West Union, WV 26456

Dear Sir or Ma'am,

You are receiving this letter because you have been identified as a land surface and/or mineral rights owner for property or adjacent property related to the proposed development project identified by the following page.

No action is required of you. This letter is simply to inform you of the proposed development.

If you would like to comment on this proposed project, or would like additional information, you may contact the Doddridge County Floodplain Manager at the above address.

Respectfully yours,

Edwin L. Wriston  
Doddridge County Floodplain Manager  
304.873.2631  
[doddridgecountyfpm@gmail.com](mailto:doddridgecountyfpm@gmail.com)

7013 2250 0001 6914 9084

U.S. Postal Service  
**CERTIFIED MAIL™ RECEIPT**  
(Domestic Mail Only; No Insurance Coverage Provided)

For delivery information visit our website at [www.usps.com](http://www.usps.com)

**OFFICIAL USE**

Postage \$  
Certified Fee  
Return Receipt Fee  
(Endorsement Required)  
Restricted Delivery Fee  
(Endorsement Required)

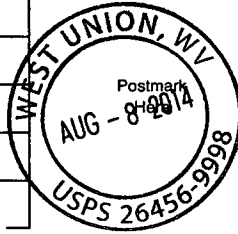

#14-247  
David & Linda Davis  
Rt 1 Box 393  
Salem, WV 26426

See Reverse for Instructions

7013 2250 0001 6914 9077

U.S. Postal Service  
**CERTIFIED MAIL™ RECEIPT**  
(Domestic Mail Only; No Insurance Coverage Provided)

For delivery information visit our website at [www.usps.com](http://www.usps.com)

**OFFICIAL USE**

Postage \$  
Certified Fee  
Return Receipt Fee  
(Endorsement Required)  
Restricted Delivery Fee  
(Endorsement Required)

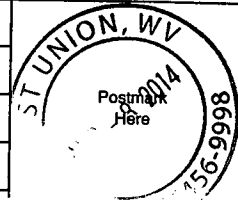

#14-247  
Samuel Hileman Estate  
435 17th St NW  
Barberton, OH 44203

See Reverse for Instructions

7013 2250 0001 6914 9060

U.S. Postal Service  
**CERTIFIED MAIL™ RECEIPT**  
(Domestic Mail Only; No Insurance Coverage Provided)

For delivery information visit our website at [www.usps.com](http://www.usps.com)

**OFFICIAL USE**

Postage \$  
Certified Fee  
Return Receipt Fee  
(Endorsement Required)  
Restricted Delivery Fee  
(Endorsement Required)

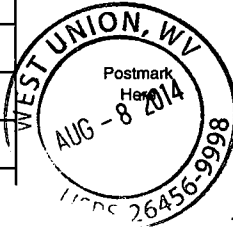

#14-247  
John Kimball Royall  
2226 Hill St  
Petersburg, VA 23803

See Reverse for Instructions

7013 2250 0001 6914 9053

U.S. Postal Service  
**CERTIFIED MAIL™ RECEIPT**  
(Domestic Mail Only; No Insurance Coverage Provided)

For delivery information visit our website at [www.usps.com](http://www.usps.com)

**OFFICIAL USE**

Postage \$  
Certified Fee  
Return Receipt Fee  
(Endorsement Required)  
Restricted Delivery Fee  
(Endorsement Required)

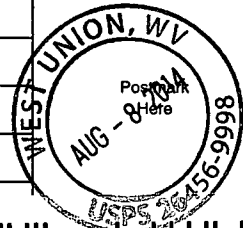

#14-247  
Richard Keith Jozwick  
Rt 1 Box 394  
Salem, WV 26426

**SENDER: COMPLETE THIS SECTION**

- Complete items 1, 2, and 3. Also complete item 4 if Restricted Delivery is desired.
- Print your name and address on the reverse so that we can return the card to you.
- Attach this card to the back of the mailpiece, or on the front if space permits.

1. Article Addressed to:

#14-247  
 Samuel Hileman Estate  
 435 17th St NW  
 Barberton, OH 44203

2. Article Number

*(Transfer from service label)*

7013 2250 0001 6914 9077

**COMPLETE THIS SECTION ON DELIVERY**

A. Signature

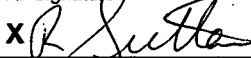
X  Agent Addressee

B. Received by (Printed Name)

R Sutter

C. Date of Delivery

8/18/14

D. Is delivery address different from item 1?  YesIf YES, enter delivery address below:  No

3. Service Type

 Certified Mail® Priority Mail Express™ Registered Return Receipt for Merchandise Insured Mail Collect on Delivery

4. Restricted Delivery? (Extra Fee)

 Yes

UNITED STATES POSTAL SERVICE



First-Class Mail  
Postage & Fees Paid  
USPS  
Permit No. G-10

- Sender: Please print your name, address, and ZIP+4 in this box.

#14-  
Doddridge County FPM  
118 East Court St STE 102  
West Union, WV 26456-1262

DOODRIDGE COUNTY, WV  
FEDERAL  
AUG 20 PM 2:05

FILED

**SENDER: COMPLETE THIS SECTION**

- Complete items 1, 2, and 3. Also complete item 4 if Restricted Delivery is desired.
- Print your name and address on the reverse so that we can return the card to you.
- Attach this card to the back of the mailpiece, or on the front if space permits.

1. Article Addressed to:

#14-247  
 David & Linda Davis  
 Rt 1 Box 393  
 Salem, WV 26426

2. Article Number  
 (Transfer from service label)

7013 2250 0001 6914 9084

**COMPLETE THIS SECTION ON DELIVERY**

A. Signature

X

*Linda Davis*  Agent  
 Addressee

B. Received by (Printed Name)

*Linda Davis*

C. Date of Delivery

*8/9/14*

D. Is delivery address different from item 1?  Yes  
 If YES, enter delivery address below:  No

3. Service Type

- Certified Mail®  Priority Mail Express™  
 Registered  Return Receipt for Merchandise  
 Insured Mail  Collect on Delivery

4. Restricted Delivery? (Extra Fee)  Yes

UNITED STATES POSTAL SERVICE



First-Class Mail  
Postage & Fees Paid  
USPS  
Permit No. G-10

09252200

09 AUG 11

F111

• Sender: Please print your name, address, and ZIP+4® in this box •



#14-

Doddridge County FPM  
118 East Court St STE 102  
West Union, WV 26456-1262

DODD  
RIDGE  
COUNTY, WV

2011 AUG 11 AM 11:09

FILED



**SENDER: COMPLETE THIS SECTION**

- Complete items 1, 2, and 3. Also complete item 4 if Restricted Delivery is desired.
- Print your name and address on the reverse so that we can return the card to you.
- Attach this card to the back of the mailpiece, or on the front if space permits.

1. Article Addressed to:

#14-247  
 John Kimball Royall  
 2226 Hill St  
 Petersburg, VA 23803

2. Article Number  
 (Transfer from service label)

7013 2250 0001 6914 9060

PS Form 3811, July 2013

Domestic Return Receipt

**COMPLETE THIS SECTION ON DELIVERY**

A. Signature

X 

- Agent  
 Addressee

B. Received by (Printed Name)

C. Date of Delivery

- D. Is delivery address different from item 1?  Yes  
 If YES, enter delivery address below:  No

3. Service Type

- Certified Mail®  Priority Mail Express™  
 Registered  Return Receipt for Merchandise  
 Insured Mail  Collect on Delivery

4. Restricted Delivery? (Extra Fee)  Yes

UNITED STATES POSTAL SERVICE

RICHMOND VA 23211



First-Class Mail  
Postage & Fees Paid  
USPS  
Permit No. G-40

19 AUG 2014 P14 8 2

• Sender: Please print your name, address, and ZIP+4® in this box •



#14-

Doddridge County FPM  
118 East Court St STE 102  
West Union, WV 26456-1262

Legal Advertisement:  
Doddridge County  
Floodplain Permit Application

Please take notice that on the 18<sup>th</sup> day of July, 2014

**Crestwood Marcellus Midstream LLC**

filed an application for a Floodplain Permit to develop land located at or about:

**39.25416N / 80.632602W to 39.257215N / 80.650686W**

**Permit #14-247 Tie-In to Susie Jane Pipeline**

The Application is on file with the Clerk of the County Court and may be inspected or copied during regular business hours. Any interested persons who desire to comment shall present the same in writing by **August 27, 2014**, delivered to:

Clerk of the County Court

118 E. Court Street, West Union, WV 26456

Beth A Rogers, Doddridge County Clerk

Edwin L. "Bo" Wriston. Doddridge County Flood Plain Manager

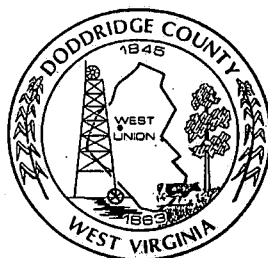

# Commercial/Industrial Floodplain Development Permit

## Doddridge County, WV Floodplain Management

This permit has been issued to **Crestwood Marcellus Midstream, LLC**, and is for the approved commercial and/or industrial development project associated with this permit that impacts the FEMA-designated floodplain and/or floodway of Doddridge County, WV, pursuant to the rules and regulations established by all applicable Federal, State and local laws and ordinances, including the Doddridge County Floodplain Ordinance. This permit must be posted at the site of work as to be clearly visible, and must remain posted during entirety of development.

**Permit: #14-247 ~ Tie in to Susie James Pipeline  
Thrasher Project #101-070-0288**

**Date Approved: 08/28/2014**

**Expires: 08/28/2015**

**Issued to: CMM via Thrasher Group**

**POC: Michael Fluharty  
304-624-4108**

**Company Address: 600 White Oaks BLVD  
Bridgeport, WV 26330**

**Lat/Long: 39.25416N/80.632602W to 39.257215N/80.650686W**

**Purpose of development: Pipeline construction.**

**Issued by: Edwin L. "Bo" Wriston, Doddridge County FPM (or designee)**

**Date: 08/28/2014**

---

For additional information regarding this permit, please contact Doddridge County Floodplain Manager at 304.873.2631, or via email at [doddridgecountyfpm@gmail.com](mailto:doddridgecountyfpm@gmail.com) 118 East Court Street; West Union, WV 26456

---

Legal Advertisement:  
Doddridge County  
Floodplain Permit Application

Please take notice that on the 18<sup>th</sup> day of July, 2014

**Crestwood Marcellus Midstream LLC**

filed an application for a Floodplain Permit to develop land located at or about:

**39.25416N / 80.632602W to 39.257215N / 80.650686W**

**Permit #14-247 Tie-In to Susie Jane Pipeline**

The Application is on file with the Clerk of the County Court and may be inspected or copied during regular business hours. Any interested persons who desire to comment shall present the same in writing by **August 27, 2014**, delivered to:

Clerk of the County Court

118 E. Court Street, West Union, WV 26456

Beth A Rogers, Doddridge County Clerk

Edwin L. "Bo" Wriston. Doddridge County Flood Plain Manager

Re.

Check Total: \$2,134.00

07/17/2014

Pay To DODDRIDGE COUNTY COMMISSION

Check No. 82972

Invoice No.	Invoice Date	Invoice Amount	Amount Due	Discount	Apply	Balance
17JUL14-A	07/17/2014	2,134.00	2,134.00	0.00	2,134.00	0.00

FLOODPLAIN PERMIT FOR THE TIE-IN SUSIE JANE PIPELINE PROJECT NO. 101-070-0288

SF4001HG-1SC

REORDER FROM YOUR LOCAL SAFEGUARD DISTRIBUTOR, IF UNKNOWN, CALL 800-523-2422

C4D1MW0010000 B14SF009096

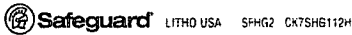

### Doddridge County, West Virginia

RECEIPT NO: 2677

DATE: 2014/08/05

FROM: THE THRASHER GROUP INC AMOUNT: \$ 2,134.00

TWO THOUSAND ONE HUNDRED THIRTY FOUR DOLLARS AND 00 CENTS

FOR: #14-247 CRESTWOOD TIE IN TO SUSIE JANE PIPE LINE

0000082972 FP-BUILDING PERMITS

020-318

TOTAL: \$2,134.00

MICHAEL HEADLEY  
SHERIFF & TREASURER

MEC  
CLERK

Customer Copy

**DODDRIDGE COUNTY  
FLOODPLAIN APPLICATION PERMIT FEES**

**Accessory Building and/or Appurtenant Structures** ----- **\$100.00**  
(examples: garage, storage or pole building, carport)  
(the total cost of which do not exceed \$10,000.00)

**Accessory Building and/or Appurtenant Structures, Additions and/or Substantial Improvement to Single Family Residential or Manufactured Homes, New Single or Multi-Family Residential and Commercial Structures or Substantial Improvement to existing Commercial Structures, Commercial Land Use Changes and Land Altering Activities**  
(commercial structures includes buildings used for business purposes)  
(the total costs of which exceed \$10,000.00 but do not exceed \$50,000.00) ----- **\$250.00**

**Accessory Building and/or Appurtenant Structures, Additions and/or Substantial Improvement to Single Family Residential or Manufactured Homes, New Single or Multi-Family Residential and Commercial Structures or Substantial Improvement to existing Commercial Structures, Commercial Land Use Changes and Land Altering Activities**  
(commercial structures includes buildings used for business purposes)  
(the total costs of which exceed \$50,000.00 plus \$2.00 per \$1,000.00 to cover costs over \$50,000.00) ----- **\$350.00**

**New Industrial Structures or Additions and/or Substantial Improvement to Existing Industrial Structures, changes in Land Use and Land Altering Activities for Industrial purposes**  
(industrial structures includes oil and/or natural gas wells, roads, bridges, tank pads, and Buildings used or associated with oil and natural gas purposes)  
(the total costs of which do not exceed \$100,000.00) ----- **\$500.00**

**New Industrial Structures or Additions and/or Substantial Improvement to Existing Industrial Structures, changes in Land Use and Land Altering Activities for Industrial purposes**  
(industrial structures includes oil and/or natural gas wells, roads, bridges, tank pads, and Buildings used or associated with oil and natural gas purposes)  
(the total costs of which exceed \$100,000.00 plus \$5.00 per \$1,000.00 in costs over \$100,000.00) ----- **\$1,000.00**

**Maximum Fee: In no event shall any Floodplain Application Permit Fee charged under the Doddridge County Floodplain Ordinance exceed the sum of \$25,000.00.**

NO. 214-717

**INVOICE**

***West Virginia Division of Natural Resources***

Wildlife Resources Section, P.O. Box 67, Elkins, WV 26241  
Attention: Ms. Patty Fordyce

**In Account With:** The Thrasher Group, Inc.  
PO Box 940  
Bridgeport, WV 26330

**Date:** June 4, 2014

**Attention:** Mr. Jordan P. Wilcox

---

For the retrieval and compilation of information on rare, threatened and endangered species and sensitive habitats for the proposed Tie-In to Susie Jane Pipeline project in Doddridge County, WV (Project #101-070-0288).

**AMOUNT DUE: \$75.00**

Make check payable to WV Division of Natural Resources. **Please reference the invoice number on your check.** Mail to the above address and to the attention of Ms. Fordyce.



# THRASHER

# 14-247

FILED

2014 JUL 18 PM 1:25

BETH A. ROGERS  
COUNTY CLERK  
DODDRIDGE COUNTY, WV

July 17, 2014

Mr. Bo Wristen, Floodplain Supervisor  
Doddridge County Commission  
118 East Court Street  
West Union, WV 26456

**RE: *Doddridge County Location Improvement Permit  
Crestwood Marcellus Midstream, LLC  
Tie-In to Susie Jane Pipeline  
Doddridge County, West Virginia  
Thrasher Project #101-070-0288***

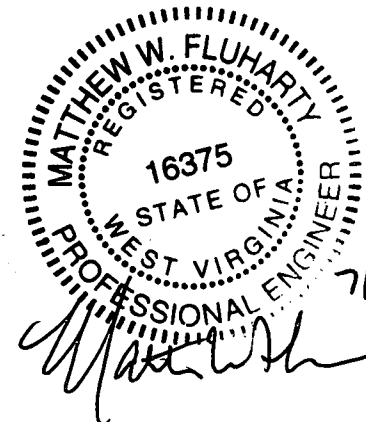

Mr. Wristen:

On behalf of Crestwood Marcellus Midstream, LLC (Crestwood), The Thrasher Group, Inc., is submitting to your office for review and approval an application package for a Doddridge County Location Improvement Permit for a proposed pipeline in the USGS Smithfield 7.5 minute quadrangle of Doddridge County, WV and FIRM panel 145 of 325. The proposed area of interest (AOI) for the Tie-In to Susie Jane Pipeline consists of a seventy-five foot (75') construction right-of-way (ROW). The proposed pipeline will originate at the Susie Jane Well Pad located at approximately 39.25416° N / 80.632602° W. From there, the buried 16" steel pipeline will extend northwest within a proposed 75' wide construction ROW to the tie-in location, located at approximately 39.257215° N / 80.650686° W. The proposed pipeline will be 5,700 LF in total, and its associated AOI will cover approximately 11.47 acres.

The proposed Tie-In to Susie Jane Pipeline will consist of approximately 650 LF of new pipeline located in the floodplain. The pipeline will traverse Buckeye Creek using conventional open-cut construction methods. The proposed Tie-In area will consist of three (3) underground valves and will occupy a 150' x 150' (22,500 ft<sup>2</sup>). Of the 22,500 ft<sup>2</sup>, only 1,000 ft<sup>2</sup> is in the floodplain. No above ground structures will be in located within the floodplain. To access the tie-in area, 1,900 LF of 20' wide access road will be constructed in the floodplain, which includes construction of a 20' x 50' bridge over Buckeye Creek. Please see attached HEC-RAS report.

Enclosed is a check for \$2,134.00 which covers the permit fee. The permit fee was calculated by the following:

Access road in floodplain: (\$87/LF) (1900 LF) = \$165,300

Bridge construction in floodplain: (\$212,000) = \$212,000

Pipeline construction in floodplain: (\$230/LF) (650) = \$149,500

Total construction cost in floodplain = \$526,800

# THRASHER

Doddridge County Commission  
July 17, 2014  
Page 2 of 2

Per Doddridge Counties Floodplain Permit Fee Sheet:  
 $\$526,800 - \$1000 = \$426,800 / \$1,000 = \$426.8 \times \$5.00 = \$2,134.00$

The USGS topographical map, aerial imagery map, FIRM map, and WV Flood Tool Map contained herein depict the proposed limits of disturbance associated with the proposed construction. Additionally, please see attached permit application, and permit fee worksheet, as well as copies of all required federal and state permit applications. No above-ground structures are proposed to be constructed within the 100 year floodplain.

Note that all required federal and state permit applications have been submitted for the project and are attached. Approvals will be forwarded to your office upon receipt.

If any further documentation is required for this project, or if any questions should arise, please feel free to contact me at your convenience at (304) 624-4108 or [jwilcox@thrashereng.com](mailto:jwilcox@thrashereng.com).

Sincerely,

THRASHER GROUP, INC.

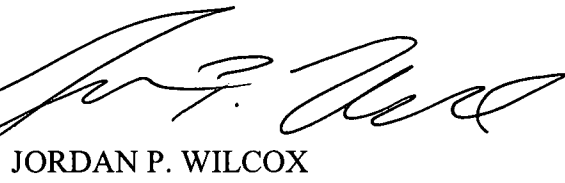

JORDAN P. WILCOX  
Environmental Scientist

Enclosures

**DODDRIDGE COUNTY  
FLOODPLAIN DEVELOPMENT PERMIT APPLICATION**

**SECTION 1: GENERAL PROVISIONS (APPLICANT TO READ AND SIGN)**

1. No work may start until a permit is issued.
2. The permit may be revoked if any false statements are made herein.
3. If revoked, all work must cease until permit is re-issued.
4. Development shall not be used or occupied until a Certificate of Compliance is issued.
5. The permit will expire if no work is commenced within six months of issuance.
6. Applicant is hereby informed that other permits may be required to fulfill local, state, and federal requirements.
7. Applicant hereby gives consent to the Floodplain Administrator/Manager or his/her representative to make inspections to verify compliance.
8. **I, THE APPLICANT CERTIFY THAT ALL STATEMENTS HEREIN AND IN ATTACHMENTS TO THIS APPLICATION ARE TO THE BEST OF MY KNOWLEDGE, TRUE AND ACCURATE.**

APPLICANT'S SIGNATURE \_\_\_\_\_

*Matthew W. [Signature]*

DATE \_\_\_\_\_

*7/17/14*

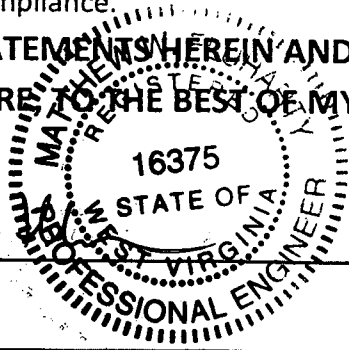

**SECTION 2: PROPOSE DEVELOPMENT (TO BE COMPLETED BY APPLICANT).**

**IF THE APPLICANT IS NOT A NATURAL PERSON, THE NAME, ADDRESS, AND TELEPHONE NUMBER OF A NATURAL PERSON WHO SHALL BE APPOINTED BY THE APPLICANT TO RECEIVE NOTICE PURSUANT TO ANY PROVISION OF THE CURRENT DODDRIDGE COUNTY FLOODPLAIN ORDINANCE.**

**APPLICANT'S NAME:** Crestwood Marcellus Midstream LLC

**ADDRESS:** 801 Cherry St., Suite 3800 Fort Worth, TX 76102

**TELEPHONE NUMBER:** (817) 339-5400

**BUILDER'S NAME:** \_\_\_\_\_

**ADDRESS:** \_\_\_\_\_

**TELEPHONE NUMBER:** \_\_\_\_\_

**ENGINEER'S NAME:** MATTHEW W. FLUHARTY, PE, The Thrasher Group, Inc.

**ADDRESS:** 600 White Oaks Blvd., Bridgeport, WV 26330

**TELEPHONE NUMBER:** (304) 624-4108

**PROJECT LOCATION:**

**NAME OF SURFACE OWNER/OWNERS (IF NOT THE APPLICANT)** Please see attached.

**ADDRESS OF SURFACE OWNER/OWNERS (IF NOT THE APPLICANT)** \_\_\_\_\_

**DISTRICT:** \_\_\_\_\_

**DATE/FROM WHOM PROPERTY  
PURCHASED:** \_\_\_\_\_

**LAND BOOK DESCRIPTION:** \_\_\_\_\_

**DEED BOOK REFERENCE:** \_\_\_\_\_

**TAX MAP REFERENCE:** \_\_\_\_\_

**EXISTING BUILDINGS/USES OF PROPERTY:** \_\_\_\_\_

**NAME OF AT LEAST ONE ADULT RESIDING IN EACH RESIDENCE LOCATED UPON THE SUBJECT  
PROPERTY** \_\_\_\_\_

**ADDRESS OF AT LEAST ONE ADULT RESIDING IN EACH RESIDENCE LOCATED UPON THE  
SUBJECT PROPERTY** \_\_\_\_\_

To avoid delay in processing the application, please provide enough information to easily identify the project location.

**DESCRIPTION OF WORK (CHECK ALL APPLICABLE BOXES)**

**A. STRUCTURAL DEVELOPMENT**

**ACTIVITY**

**STRUCTURAL TYPE**

- |  |   |
|--|---|
| <input type="checkbox"/> New Structure           | <input type="checkbox"/> Residential (1 – 4 Family)       |
| <input type="checkbox"/> Addition                | <input type="checkbox"/> Residential (more than 4 Family) |
| <input type="checkbox"/> Alteration              | <input type="checkbox"/> Non-residential (floodproofing)  |
| <input type="checkbox"/> Relocation              | <input type="checkbox"/> Combined Use (res. & com.)       |
| <input type="checkbox"/> Demolition              | <input type="checkbox"/> Replacement                      |
| <input type="checkbox"/> Manufactured/Mobil Home |   |

**B. OTHER DEVELOPMENT ACTIVITIES:**

- Fill             Mining             Drilling             Pipelining
- Grading
- Excavation (except for STRUCTURAL DEVELOPMENT checked above)
- Watercourse Altercation (including dredging and channel modification)
- Drainage Improvements (including culvert work)
- Road, Street, or Bridge Construction
- Subdivision (including new expansion)
- Individual Water or Sewer System
- Other (please specify)
- 

**C. STANDARD SITE PLAN OR SKETCH**

1. SUBMIT ALL STANDARD SITE PLANS, IF ANY HAVE BEEN PREPARED.
2. IF STANDARD SITE PLANS HAVE NOT BEEN PREPARED:  
SKETCH ON A SEPARATE 8 ½ X 11 INCH SHEET OF PAPER THE SHAPE AND LOCATION OF THE LOT. SHOW THE LOCATION OF THE INTENDED CONSTRUCTION OR LAND USE INDICATING BUILDING SETBACKS, SIZE & HEIGHT. IDENTIFY EXISTING BUILDINGS, STRUCTURES OR LAND USES ON THE PROPERTY.
3. SIGN AND DATE THE SKETCH.

**ACTUAL TOTAL CONSTRUCTION COSTS OF THE COMPLETE DEVELOPMENT IRRESPECTIVE OF WHETHER ALL OR ANY PART OF THE SUBJECT PROPOSED CONSTRUCTION PROJECT IS WITHIN THE FLOODPLAIN \$ 526,000**

**D. ADJACENT AND/OR AFFECTED LANDOWNERS:**

1. NAME AND ADDRESS OF ALL OWNERS OF SURFACE TRACTS ADJACENT TO THE AREA OF THE SURFACE TRACT (UP & DOWN STREAM) UPON WHICH THE PROPOSED ACTIVITY WILL OCCUR AND ALL OTHER SURFACE OWNERS UP & DOWN STREAM) WHO OWN PROPERTY THAT MAY BE AFFECTED BY FLOODING AS IS DEMONSTRATED BY A FLOODPLAIN STUDY OR SURVEY (IF ONE HAS BEEN COMPLETED).

NAME: \_\_\_\_\_  
ADDRESS: \_\_\_\_\_  
\_\_\_\_\_

NAME: \_\_\_\_\_  
ADDRESS: \_\_\_\_\_  
\_\_\_\_\_

NAME: \_\_\_\_\_  
ADDRESS: \_\_\_\_\_  
\_\_\_\_\_

NAME: \_\_\_\_\_  
ADDRESS: \_\_\_\_\_  
\_\_\_\_\_

1. NAME AND ADDRESS OF AT LEAST ONE ADULT RESIDING IN EACH RESIDENCE LOCATED UPON ANY ADJACENT PROPERTY AT THE TIME THE FLOODPLAIN PERMIT APPLICATION IS FILED AND THE NAME AND ADDRESS OF AT LEAST ONE ADULT RESIDING IN ANY HOME ON ANY PROPERTY THAT MAY BE AFFECTED BY FLOODING AS IS DEMONSTRATED BY A FLOODPLAIN STUDY OR SURVEY.

NAME: \_\_\_\_\_  
ADDRESS: \_\_\_\_\_  
\_\_\_\_\_

NAME: \_\_\_\_\_  
ADDRESS: \_\_\_\_\_  
\_\_\_\_\_

NAME: \_\_\_\_\_  
ADDRESS: \_\_\_\_\_  
\_\_\_\_\_

NAME: \_\_\_\_\_  
ADDRESS: \_\_\_\_\_  
\_\_\_\_\_

### E. CONFIRMATION FORM

THE APPLICANT ACKNOWLEDGES, AGREES, AND CONFIRMS THAT HE/IT WILL PAY WITHIN 30 DAYS OF RECEIPT OF INVOICE BY THE COUNTY FOR ALL EXPENSES RELATIVE TO THE PERMIT APPLICATION PROCESS GREATER THAN THE REQUIRED DEPOSIT FOR EXPENSES INCLUDING:

- (A) PERSONAL SERVICE OF PROCESS BY THE DODDRIDGE COUNTY SHERIFF AT THE RATES PERMITTED BY LAW FOR SUCH SERVICE.
- (B) SERVICE BY CERTIFIED MAIL RETURN RECEIPT REQUESTED.
- (C) PUBLICATION.

### Surface Owner

Dist. Name	Dis.	Map	Par	Sub	Owner	Address	City,St.,Zip	Location	Book	Page	Legal Desc.
GREENBRIER	4	3	14		JOZWICK RICHARD KEITH (LIFE)	RT 1 BOX 394	SALEM, WV 26426	SALEM RD 15	262	25	BUCKEYE FORK OF M I CREEK 181.25 AC

### Downstream Surface Owner

Dist. Name	Dis.	Map	Par	Sub	Owner	Address	City,St.,Zip	Location	Book	Page	Legal Desc.
GREENBRIER	4	3	8		ROYALL JOHN KIMBALL	2226 HILL ST	PETERSBURG,V A, 23803	SALEM RD 1 RT 15 & 42	MB15	624	GREENBRIER CREEK 20 AC

### Upstream Surface Owner

Dist. Name	Dis.	Map	Par	Sub	Owner	Address	City,St.,Zip	Location	Book	Page	Legal Desc.
GREENBRIER	4	3	15		HILEMAN SAMUEL ESTATE %	435 17TH ST NW	BARBERTON, OH 44203	RT 15	AB39	449	BUCKEYE 1.75 AC
GREENBRIER	4	3	23		DAVIS DAVID & LINDA	RT 1 BOX 393	SALEM, WV 26426		243	134	BUCKEYE 20.50 AC

- (D) COURT REPORTING SERVICES AT ANY HEARINGS REQUESTED BY THE APPLICANT.
- (E) CONSULTANTS AND/OR HEARING EXPERTS UTILIZED BY DODDRIDGE COUNTY FLOODPLAIN ADMINISTRATOR/MANAGER OR FLOODPLAIN APPEALS BOARD FOR REVIEW OF MATERIALS AND/OR TESTIMONY REGARDING THE EFFICACY OF GRANTING OR DENYING THE APPLICANT'S FLOODPLAIN PERMIT.



Matthew W Fluharty  
 \_\_\_\_\_  
 DATE: 7/17/14

After completing SECTION 2, APPLICANT should submit form to Floodplain Administrator/Manager or his/her representative for review.

**SECTION 3: FLOODPLAIN DETERMINATION (to be completed by Floodplain Administrator/Manager or his/her representative)**

**THE PROPOSED DEVELOPMENT:**

THE PROPOSED DEVELOPMENT IS LOCATED ON:

FIRM Panel: \_\_\_\_\_  
 Dated: \_\_\_\_\_

- Is **NOT** located in a Specific Flood Hazard Area (Notify applicant that the application review is complete and **NO FLOODPLAIN DEVELOPMENT PERMIT IS REQUIRED**).
- Is located in Special Flood Hazard Area.  
 FIRM zone designation \_\_\_\_\_  
 100-Year flood elevation is: \_\_\_\_\_ NGVD (MSL)
- Unavailable
- The proposed development is located in a floodway.  
 FBFM Panel No. \_\_\_\_\_ Dated \_\_\_\_\_
- See section 4 for additional instructions.



SIGNED \_\_\_\_\_

DATE \_\_\_\_\_

**SECTION 4: ADDITIONAL INFORMATION REQUIRED (To be completed by Floodplain Administrator/Manager or his/her representative)**

The applicant must submit the documents checked below before the application can be processed.

- A plan showing the location of all existing structures, water bodies, adjacent roads, lot dimensions and proposed development.
  
- Development plans, drawn to scale, and specifications, including where applicable: details for anchoring structures, storage tanks, proposed elevation of lowest floor, (including basement or crawl space), types of water resistant materials used below the first floor, details of flood proffing of utilities located below the first floor and details of enclosures below the first floor. Also \_\_\_\_\_  
\_\_\_\_\_
  
- Subdivision or other development plans (If the subdivision or development exceeds 50 lots or 5 acres, whichever is the lesser, the applicant must provide 100-year flood elevations if they are not otherwise available).
  
- Plans showing the extent of watercourse relocation and/or landform alterations.
  
- Top of new fill elevation \_\_\_\_\_ Ft. NGVD (MSL).  
For floodproofing structures applicant must attach certification from registered engineer or architect.
  
- Certification from a registered engineer that the proposed activity in a regulatory floodway will not result in any increase in the height of the 100-year flood. A copy of all data and calculations supporting this finding must also be submitted.
  
- Manufactured homes located in a floodplain area must have a West Virginia Contractor's License and a Manufactured Home Installation License as required by the Federal Emergency Management Agency (FEMA).

Other:

---

---

---

**SECTION 5: PERMIT DETERMINATION (To be completed by Floodplain Administrator/Manager or his/her representative)**

I have determined that the proposed activity **(type is or is not)** in conformance with provisions of the Floodplain Ordinance adopted by the County Commission of Doddridge County on May 21, 2013. The permit is issued subject to the conditions attached to and made part of this permit.

SIGNED \_\_\_\_\_ DATE \_\_\_\_\_

If the Floodplain Administrator/Manager found that the above was not in conformance with the provisions of the Doddridge County Floodplain Ordinance and/or denied that application, the applicant may complete an appealing process below.

APPEALS:   Appealed to the County Commission of Doddridge County?  Yes  No  
Hearing Date: \_\_\_\_\_  
County Commission Decision - Approved    Yes    No

CONDITIONS: \_\_\_\_\_  
\_\_\_\_\_  
\_\_\_\_\_  
\_\_\_\_\_

**SECTION 6: AS-BUILT ELEVATIONS (To be submitted by APPLICANT before Certificate of Compliance is issued).**

The following information must be provided for project structures. This section must be completed by a registered professional engineer or a licensed land surveyor (or attach a certification to this application).

COMPLETE 1 OR 2 BELOW:

- 1 Actual (As-Built) Elevation of the top of the lowest floor (including basement or crawl space is \_\_\_\_\_ FT. NGVD (MSL)
- 2 Actual (As Built) elevation of floodproofing is \_\_\_\_\_ FT. NGVD (MSL)

**Note:** Any work performed prior to submittal of the above information is at risk of the applicant.

**SECTION 7: COMPLIANCE ACTION (To be completed by the Floodplain Administrator/Manager or his/her representative).**

The Floodplain Administrator/Manager or his/her representative will complete this section as applicable based on inspection of the project to ensure compliance with the Doddridge County Floodplain Ordinance.

**INSPECTIONS:**

DATE: \_\_\_\_\_ BY: \_\_\_\_\_  
DEFICIENCIES ?      Y/N

COMMENTS \_\_\_\_\_  
\_\_\_\_\_  
\_\_\_\_\_  
\_\_\_\_\_  
\_\_\_\_\_

**SECTION 8: CERTIFICATE OF COMPLIANCE (To be completed by Floodplain Administrator/Manager or his/her representative).**

Certificate of Compliance issued: DATE: \_\_\_\_\_ BY: \_\_\_\_\_

**CERTIFICATE OF COMPLIANCE  
FOR DEVELOPMENT IN SPECIAL FLOOD HAZARD AREA  
(OWNER MUST RETAIN)**

**PERMIT NUMBER:** \_\_\_\_\_

**PERMIT DATE:** \_\_\_\_\_

**PURPOSE –**

**CONSTRUCTION LOCATION:** \_\_\_\_\_

**OWNER'S ADDRESS:** \_\_\_\_\_  
\_\_\_\_\_  
\_\_\_\_\_

**THE FOLLOWING MUST BE COMPLETED BY THE FLOODPLAIN  
ADMINISTRATOR/MANAGER OR HIS/HER AGENT.**

**COMPLIANCE IS HEREBY CERTIFIED WITH THE REQUIREMENT OF THE  
FLOODPLAIN ORDINANCE ADOPTED BY THE COUNTY COMMISSION OF  
DODDRIDGE COUNTY ON MAY 21, 2013.**

**SIGNED** \_\_\_\_\_ **DATE** \_\_\_\_\_

# WV Flood Map

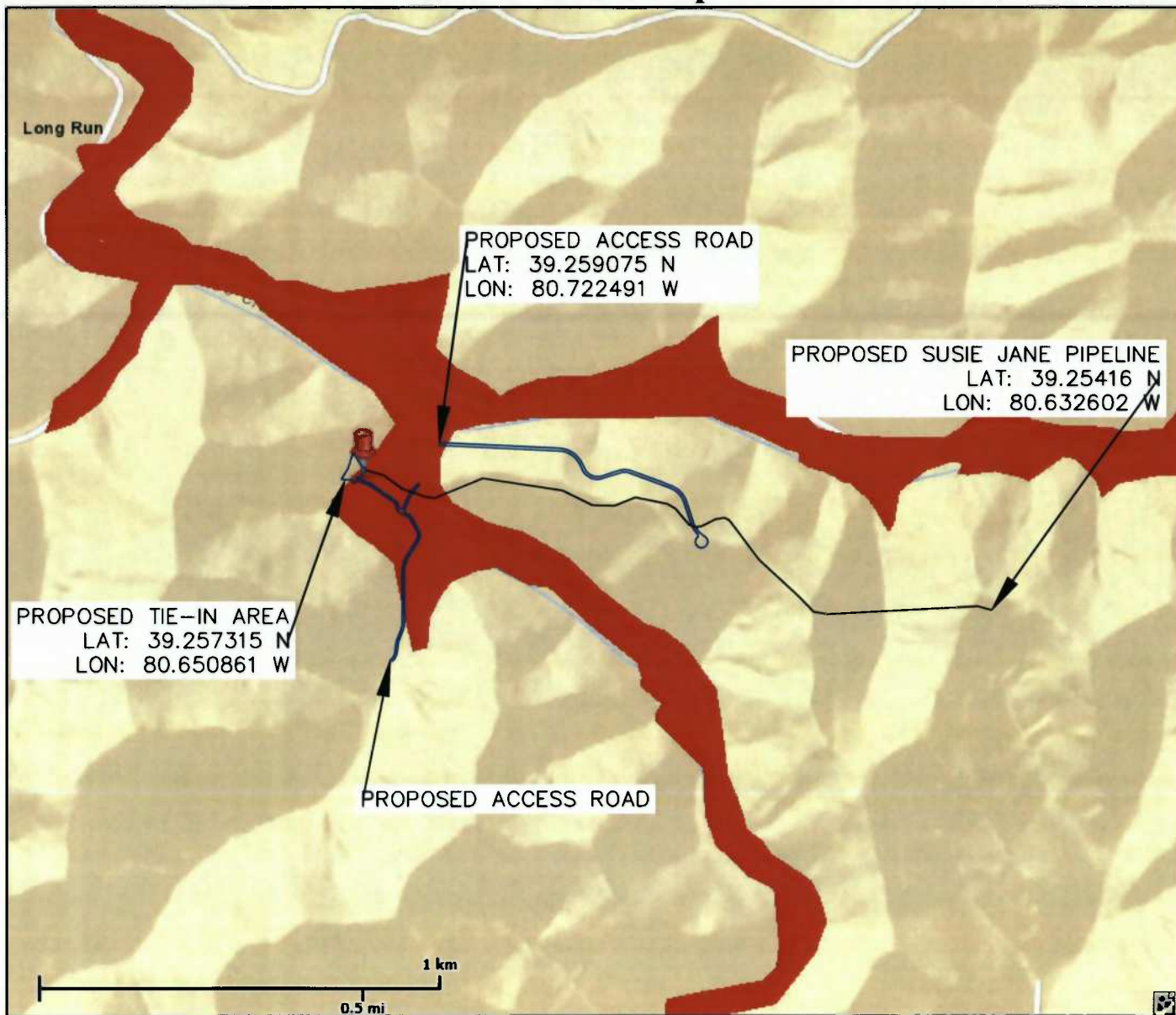

This map is not the official regulatory FIRM or DFIRM. Its purpose is to assist with determining potential flood risk for the selected location.

Map Created on 5/6/2014



Location of the mouse click



**Flood Hazard Zone**  
(1% annual chance floodplain)

User Notes:

**Disclaimer:**

The online map is for use in administering the National Flood Insurance Program. It does not necessarily identify all areas subject to flooding, particularly from local drainage sources of small size. To obtain more detailed information in areas where Base Flood Elevations have been determined, users are encouraged to consult the latest Flood Profile data contained in the official flood insurance study. These studies are available online at [www.msc.fema.gov](http://www.msc.fema.gov).

WV Flood Tool is supported by FEMA, WV NFIP Office, and WV GIS Technical Center  
(<http://www.MapWV.gov/flood>)

**Flood Hazard Area:**

**Elevation:** N/A

**Location (long, lat):**

**Location (UTM 17N):**

**FEMA Issued Flood Map:**

**Contacts:**

**CRS Information:**

**Parcel Number:**

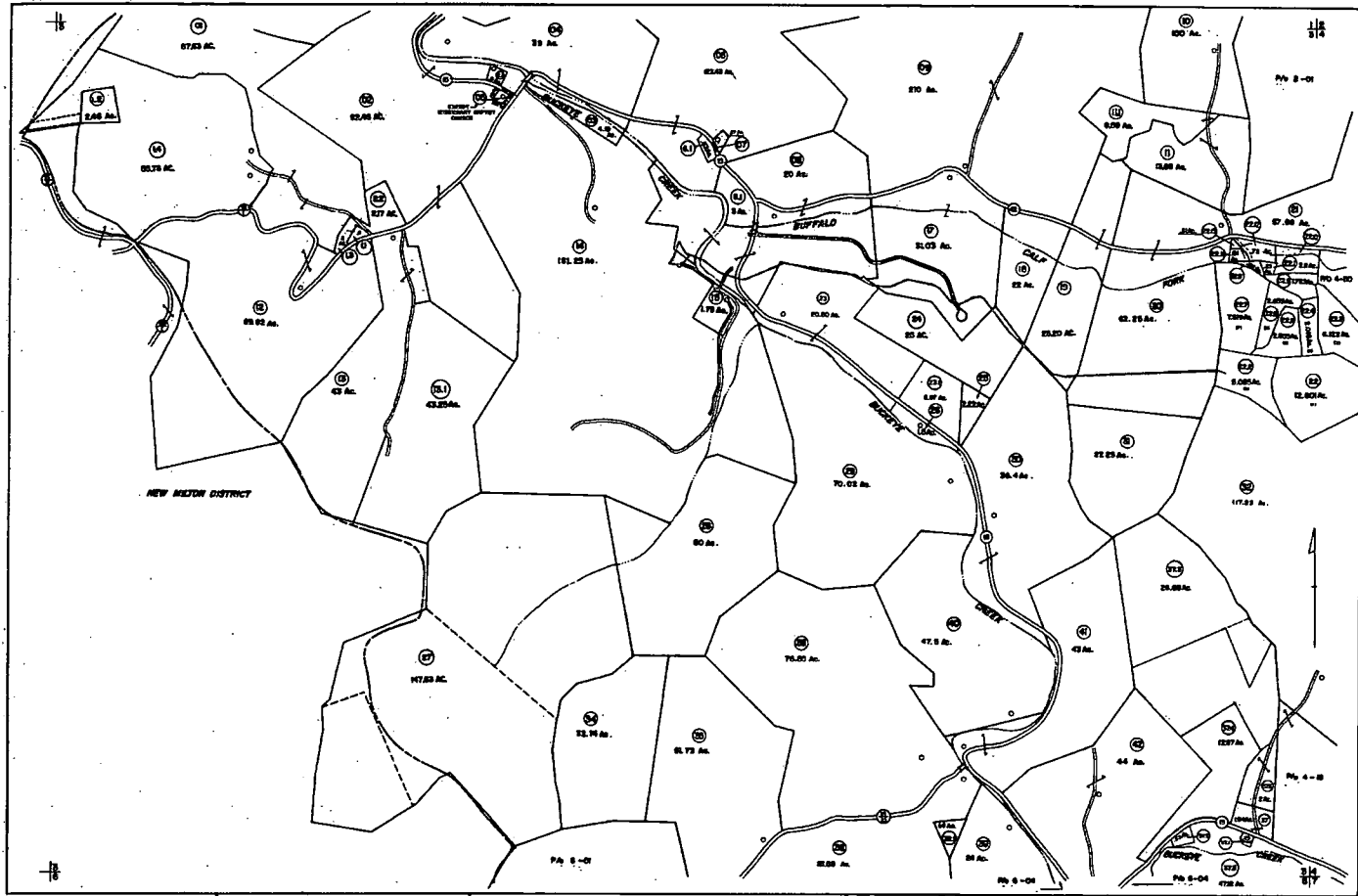

FOR TAX PURPOSES ONLY

Map by  
L. SCOTT KEMMEL  
County Surveyor  
Martinsburg, Pennsylvania

Legend

Property line  
Map of section in survey  
County line  
Municipal line  
Water line

Survey for tax  
Road for location  
Number of acres within tract  
Municipal boundary  
Water

Section		Section		Section	
Acres	Value	Acres	Value	Acres	Value
1.00	1.00	1.00	1.00	1.00	1.00
2.00	2.00	2.00	2.00	2.00	2.00
3.00	3.00	3.00	3.00	3.00	3.00
4.00	4.00	4.00	4.00	4.00	4.00
5.00	5.00	5.00	5.00	5.00	5.00
6.00	6.00	6.00	6.00	6.00	6.00
7.00	7.00	7.00	7.00	7.00	7.00
8.00	8.00	8.00	8.00	8.00	8.00
9.00	9.00	9.00	9.00	9.00	9.00
10.00	10.00	10.00	10.00	10.00	10.00
11.00	11.00	11.00	11.00	11.00	11.00
12.00	12.00	12.00	12.00	12.00	12.00
13.00	13.00	13.00	13.00	13.00	13.00
14.00	14.00	14.00	14.00	14.00	14.00
15.00	15.00	15.00	15.00	15.00	15.00
16.00	16.00	16.00	16.00	16.00	16.00
17.00	17.00	17.00	17.00	17.00	17.00
18.00	18.00	18.00	18.00	18.00	18.00
19.00	19.00	19.00	19.00	19.00	19.00
20.00	20.00	20.00	20.00	20.00	20.00
21.00	21.00	21.00	21.00	21.00	21.00
22.00	22.00	22.00	22.00	22.00	22.00
23.00	23.00	23.00	23.00	23.00	23.00
24.00	24.00	24.00	24.00	24.00	24.00
25.00	25.00	25.00	25.00	25.00	25.00
26.00	26.00	26.00	26.00	26.00	26.00
27.00	27.00	27.00	27.00	27.00	27.00
28.00	28.00	28.00	28.00	28.00	28.00
29.00	29.00	29.00	29.00	29.00	29.00
30.00	30.00	30.00	30.00	30.00	30.00
31.00	31.00	31.00	31.00	31.00	31.00
32.00	32.00	32.00	32.00	32.00	32.00
33.00	33.00	33.00	33.00	33.00	33.00
34.00	34.00	34.00	34.00	34.00	34.00
35.00	35.00	35.00	35.00	35.00	35.00
36.00	36.00	36.00	36.00	36.00	36.00
37.00	37.00	37.00	37.00	37.00	37.00
38.00	38.00	38.00	38.00	38.00	38.00
39.00	39.00	39.00	39.00	39.00	39.00
40.00	40.00	40.00	40.00	40.00	40.00
41.00	41.00	41.00	41.00	41.00	41.00
42.00	42.00	42.00	42.00	42.00	42.00
43.00	43.00	43.00	43.00	43.00	43.00
44.00	44.00	44.00	44.00	44.00	44.00
45.00	45.00	45.00	45.00	45.00	45.00
46.00	46.00	46.00	46.00	46.00	46.00
47.00	47.00	47.00	47.00	47.00	47.00
48.00	48.00	48.00	48.00	48.00	48.00
49.00	49.00	49.00	49.00	49.00	49.00
50.00	50.00	50.00	50.00	50.00	50.00
51.00	51.00	51.00	51.00	51.00	51.00
52.00	52.00	52.00	52.00	52.00	52.00
53.00	53.00	53.00	53.00	53.00	53.00
54.00	54.00	54.00	54.00	54.00	54.00
55.00	55.00	55.00	55.00	55.00	55.00
56.00	56.00	56.00	56.00	56.00	56.00
57.00	57.00	57.00	57.00	57.00	57.00
58.00	58.00	58.00	58.00	58.00	58.00
59.00	59.00	59.00	59.00	59.00	59.00
60.00	60.00	60.00	60.00	60.00	60.00
61.00	61.00	61.00	61.00	61.00	61.00
62.00	62.00	62.00	62.00	62.00	62.00
63.00	63.00	63.00	63.00	63.00	63.00
64.00	64.00	64.00	64.00	64.00	64.00
65.00	65.00	65.00	65.00	65.00	65.00
66.00	66.00	66.00	66.00	66.00	66.00
67.00	67.00	67.00	67.00	67.00	67.00
68.00	68.00	68.00	68.00	68.00	68.00
69.00	69.00	69.00	69.00	69.00	69.00
70.00	70.00	70.00	70.00	70.00	70.00
71.00	71.00	71.00	71.00	71.00	71.00
72.00	72.00	72.00	72.00	72.00	72.00
73.00	73.00	73.00	73.00	73.00	73.00
74.00	74.00	74.00	74.00	74.00	74.00
75.00	75.00	75.00	75.00	75.00	75.00
76.00	76.00	76.00	76.00	76.00	76.00
77.00	77.00	77.00	77.00	77.00	77.00
78.00	78.00	78.00	78.00	78.00	78.00
79.00	79.00	79.00	79.00	79.00	79.00
80.00	80.00	80.00	80.00	80.00	80.00
81.00	81.00	81.00	81.00	81.00	81.00
82.00	82.00	82.00	82.00	82.00	82.00
83.00	83.00	83.00	83.00	83.00	83.00
84.00	84.00	84.00	84.00	84.00	84.00
85.00	85.00	85.00	85.00	85.00	85.00
86.00	86.00	86.00	86.00	86.00	86.00
87.00	87.00	87.00	87.00	87.00	87.00
88.00	88.00	88.00	88.00	88.00	88.00
89.00	89.00	89.00	89.00	89.00	89.00
90.00	90.00	90.00	90.00	90.00	90.00
91.00	91.00	91.00	91.00	91.00	91.00
92.00	92.00	92.00	92.00	92.00	92.00
93.00	93.00	93.00	93.00	93.00	93.00
94.00	94.00	94.00	94.00	94.00	94.00
95.00	95.00	95.00	95.00	95.00	95.00
96.00	96.00	96.00	96.00	96.00	96.00
97.00	97.00	97.00	97.00	97.00	97.00
98.00	98.00	98.00	98.00	98.00	98.00
99.00	99.00	99.00	99.00	99.00	99.00
100.00	100.00	100.00	100.00	100.00	100.00

STATE OF WEST VIRGINIA  
DODDRIDGE COUNTY  
Office of Assessor

GREENBRIER DISTRICT  
SHEET 03  
Date, April Photographic, 1951, 1952  
Photo No. 81-235  
Scale 1" = 400'



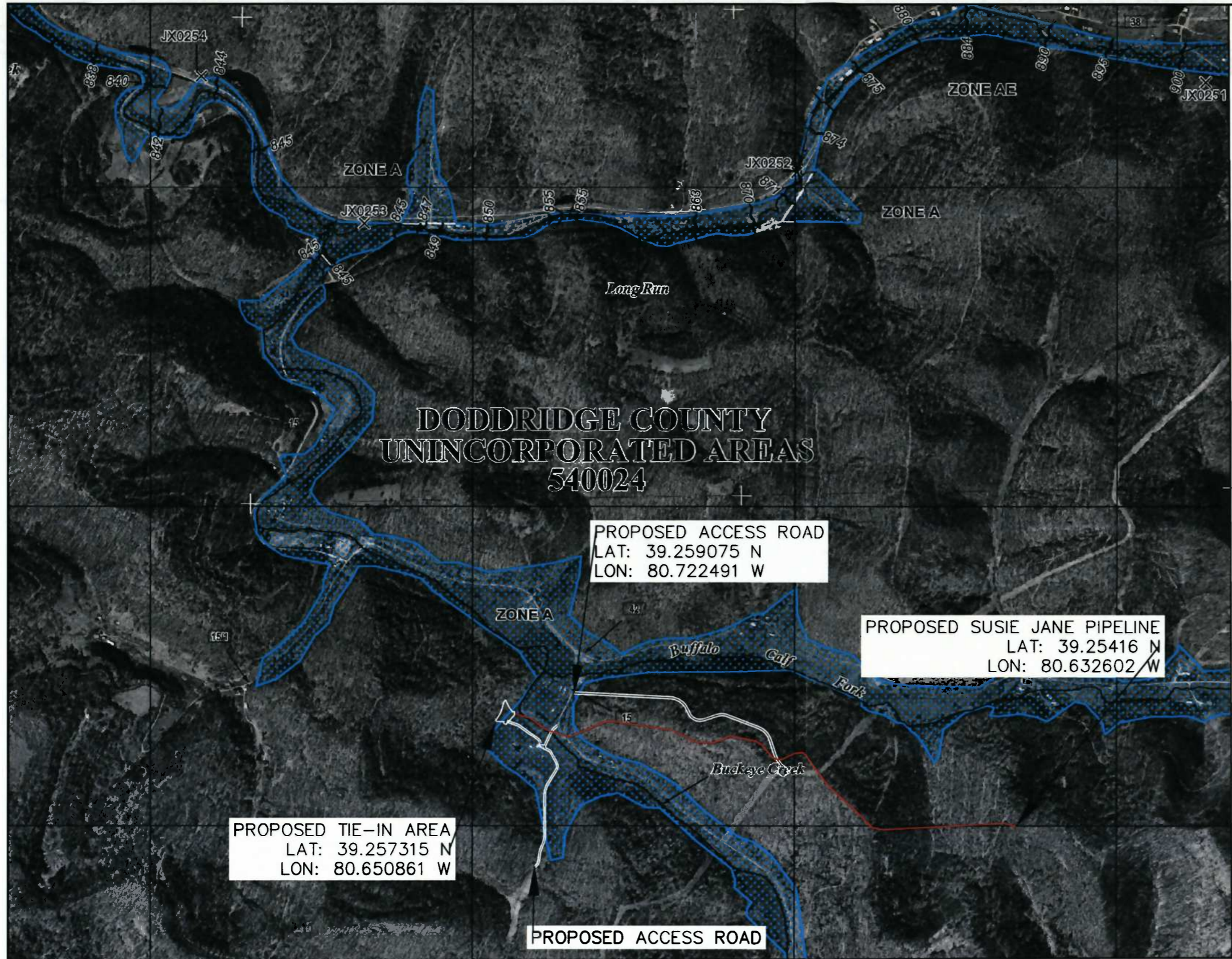

**DODDRIDGE COUNTY  
UNINCORPORATED AREAS  
540024**

PROPOSED ACCESS ROAD  
LAT: 39.259075 N  
LON: 80.722491 W

PROPOSED SUSIE JANE PIPELINE  
LAT: 39.25416 N  
LON: 80.632602 W

PROPOSED TIE-IN AREA  
LAT: 39.257315 N  
LON: 80.650861 W

PROPOSED ACCESS ROAD

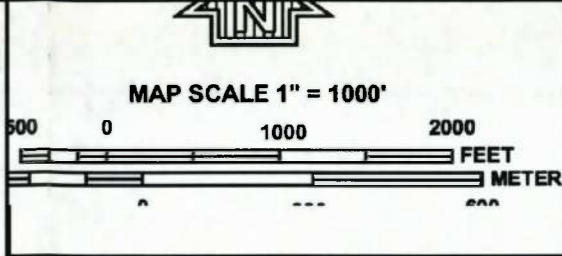

NATIONAL FLOOD INSURANCE PROGRAM

PANEL 0145C

**FIRM**  
FLOOD INSURANCE RATE MAP  
DODDRIDGE COUNTY,  
WEST VIRGINIA  
AND INCORPORATED AREAS

PANEL 145 OF 325  
(SEE MAP INDEX FOR FIRM PANEL LAYOUT)

CONTAINS:

COMMUNITY	NUMBER	PANEL	SUFFIX
DODDRIDGE COUNTY	540024	0145	C

Notice to User: The Map Number shown below should be used when placing map orders; the Community Number shown above should be used on insurance applications for the subject community.



MAP NUMBER  
54017C0145C  
MAP REVISED  
OCTOBER 4, 2011

Federal Emergency Management Agency

This is an official copy of a portion of the above referenced flood map. It was extracted using F-MIT On-Line. This map does not reflect changes or amendments which may have been made subsequent to the date on the title block. For the latest product information about National Flood Insurance Program flood maps check the FEMA Flood Map Store at [www.mec.fema.gov](http://www.mec.fema.gov)

JOINS PANEL 0235

80° 37' 3



# **Crestwood Marcellus Midstream LLC**

**Tie-In to Susie Jane Pipeline**

**THRASHER GROUP, INC. PROJECT # 101-070-0288**

## HEC-RAS Report



July 2014



## **HYDROLOGY ANALYSIS**

To determine how the proposed bridge may affect the existing floodplain of Buckeye Creek, a hydrology and hydraulic analysis was performed. The site is located in the FEMA Flood Zone 'A' and therefore, no detailed flood study or base flood elevations have been established. The size of the watershed to the location of the existing/proposed bridge is approximately 13.85 square miles.

## **HYDRAULIC ANALYSIS**

The hydraulic data and flow was gathered by using USGS Quad Maps and the USGS Regional Regression Equation for Rural Areas. Based on the drainage area and a 100 yr storm event a flow of 3,275 cfs was calculated. Stream and floodplain roughness coefficients assumed in the analysis came from HEC-RAS 4.1.0 program.

Channel	0.04	clean, winding, some pools and shoals
Floodplain	0.10	heavy stand of timber
	0.03	pasture no brush; short grass

Aerial mapping was provided by Blue Mountain Engineering (BME) of the surrounding floodplain. Cross sections were created and inserted into HEC-RAS. A hydraulic model was run to produce an existing flood elevation. Two scenarios were analyzed; the first assessed the impact of the proposed bridge while the existing bridge remains in place and the second assumes the existing bridge will be demolished.

## **CONCLUSION**

After analyzing both scenarios, the proposed bridge will increase the flood elevation at the proposed location. Looking at scenario 1 (SC1) with the existing bridge to remain the water elevation increases approximately 0.5 feet (857.65') at cross section 346.69 but does decrease as you go upstream to 0.06 feet at the end of our model at cross section 968.65.

The second scenario (SC2) looked at the existing bridge being demolished after the new bridge is constructed. The proposed bridge will then minimally increase the flood elevation. The flood elevation would be raised 0.23 feet and by station 968.65 the flood elevation is 0.04 feet above existing conditions.

There are multiple existing structures that are located near the existing/proposed flood elevation. The structure located at Stat. 639.43 appears to be located within the 100 yr flood elevation existing conditions and will see a 0.23 feet increase from scenario #1 and 0.11 feet increase from SC2. According to FEMA, where no known base flood elevation is established, the proposed disturbance is not to cause more than one foot of cumulative increase to the approximate flood

elevation (this was derived through HEC-RAS). According to the calculations, the criteria is met.

COUNTY	SHEET NO.	SHEETS
DODDRIDGE	--	--

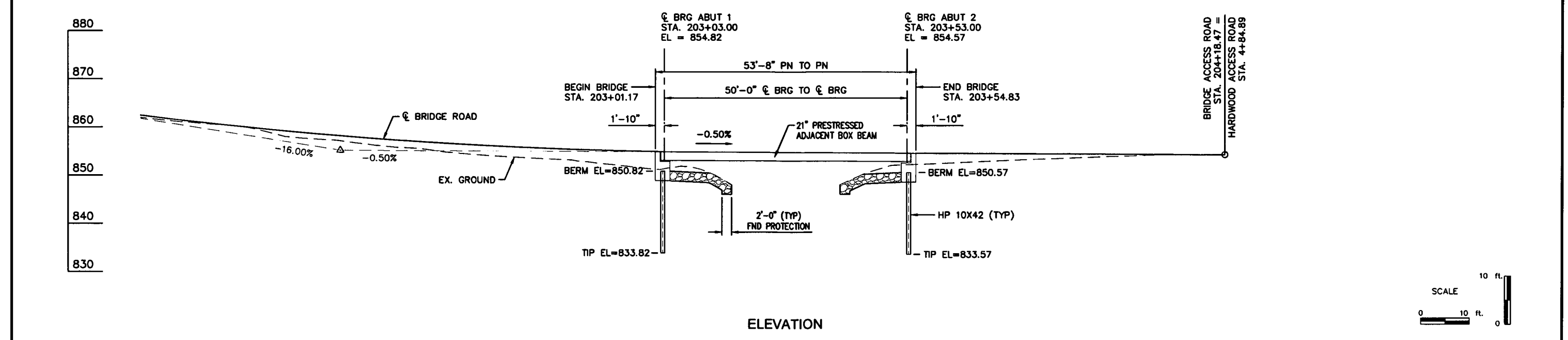
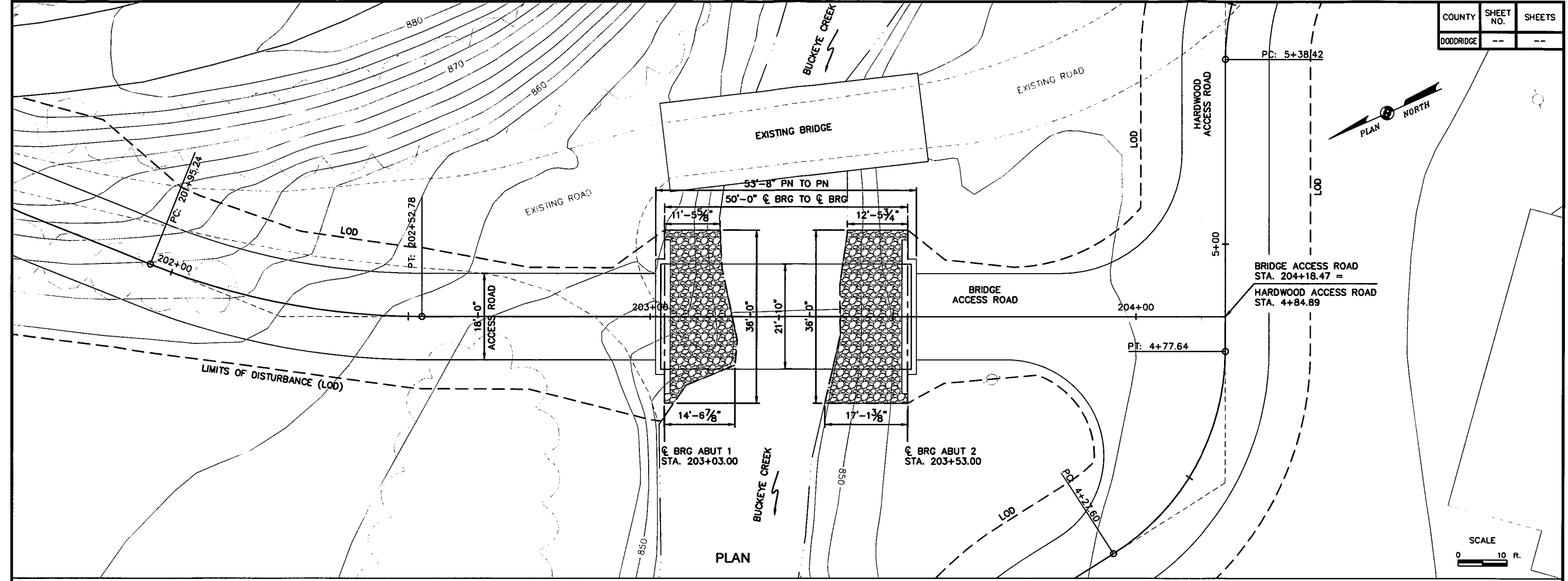

**VERTICAL CURVE DATA**

VPI STA. 202+36.06  
 EL = 855.15  
 VC = 133'

REVISION NUMBER	SHEET NUMBER	REVISIONS	DATE	BY

PLANS PREPARED FOR:



**EL. ROBINSON ENGINEERING**  
 5088 Washington Street, West  
 Charleston, West Virginia 25313  
 Phone: 304-776-7473 Fax: 304-776-6426  
 www.elrobinsoneengineering.com

HARDWOOD TO TIE-IN  
 BUCKEYE BRIDGE

DATE: MAY 2014 SHEET NO. --

CRESTWOOD MIDSTREAM PARTNERS LP

GENERAL PLAN AND ELEVATION



HEC-RAS River: Buckeye Creek Reach: STREAM CENTERLIN Profile: 100 yr

Reach	River Sta	Profile	Plan	Q Total (cfs)	Min Ch El (ft)	W.S. Elev (ft)	Crit W.S. (ft)	E.G. Elev (ft)	E.G. Slope (ft/ft)	Vel Chnl (ft/s)	Flow Area (sq ft)	Top Width (ft)	Froude # Chl
STREAM CENTERLIN	968.65	100 yr	PRO SC1	3275.00	851.97	858.97		859.96	0.003845	8.18	476.72	100.47	0.55
STREAM CENTERLIN	968.65	100 yr	PRO SC2	3275.00	851.97	858.91		859.93	0.003956	8.26	471.23	100.04	0.58
STREAM CENTERLIN	968.65	100 yr	EX	3275.00	851.97	858.87		859.90	0.004031	8.31	467.69	99.77	0.58
STREAM CENTERLIN	899.54	100 yr	PRO SC1	3275.00	851.94	858.44		859.83	0.005268	8.94	431.05	102.33	0.63
STREAM CENTERLIN	899.54	100 yr	PRO SC2	3275.00	851.94	858.34		859.58	0.005588	9.09	421.30	101.54	0.64
STREAM CENTERLIN	899.54	100 yr	EX	3275.00	851.94	858.28		859.55	0.005807	9.20	414.63	101.00	0.65
STREAM CENTERLIN	799.35	100 yr	PRO SC1	3275.00	851.90	858.21		859.03	0.004564	7.33	480.36	119.98	0.57
STREAM CENTERLIN	799.35	100 yr	PRO SC2	3275.00	851.90	858.07		858.94	0.005049	7.55	463.78	117.49	0.60
STREAM CENTERLIN	799.35	100 yr	EX	3275.00	851.90	857.97		858.86	0.005410	7.72	451.98	115.78	0.62
STREAM CENTERLIN	712.95	100 yr	PRO SC1	3275.00	849.99	858.41		858.85	0.000899	4.63	928.68	244.48	0.29
STREAM CENTERLIN	712.95	100 yr	PRO SC2	3275.00	849.99	858.28		858.53	0.001090	4.61	895.43	241.04	0.30
STREAM CENTERLIN	712.95	100 yr	EX	3275.00	849.99	858.18		858.44	0.001172	4.94	871.56	238.56	0.31
STREAM CENTERLIN	639.43	100 yr	PRO SC1	3275.00	848.88	858.35		858.61	0.001027	4.78	876.93	221.11	0.29
STREAM CENTERLIN	639.43	100 yr	PRO SC2	3275.00	848.88	858.21		858.48	0.001138	4.97	847.12	218.51	0.30
STREAM CENTERLIN	639.43	100 yr	EX	3275.00	848.88	858.10		858.39	0.001228	5.12	824.03	218.59	0.31
STREAM CENTERLIN	577.85	100 yr	PRO SC1	3275.00	848.55	857.88		858.46	0.002365	7.19	628.96	174.50	0.43
STREAM CENTERLIN	577.85	100 yr	PRO SC2	3275.00	848.55	857.64		858.32	0.002702	7.55	592.34	165.78	0.48
STREAM CENTERLIN	577.85	100 yr	EX	3275.00	848.55	857.47		858.21	0.002997	7.85	565.14	159.15	0.48
STREAM CENTERLIN	517.86	100 yr	PRO SC1	3275.00	846.85	857.94		858.30	0.001037	5.28	765.54	167.05	0.29
STREAM CENTERLIN	517.86	100 yr	PRO SC2	3275.00	846.85	857.74		858.14	0.001139	5.44	733.97	160.58	0.31
STREAM CENTERLIN	517.86	100 yr	EX	3275.00	846.85	857.59		858.01	0.001224	5.58	710.42	155.58	0.32
STREAM CENTERLIN	456.22	100 yr	PRO SC1	3275.00	847.35	857.78		858.22	0.001445	5.91	711.37	181.13	0.34
STREAM CENTERLIN	456.22	100 yr	PRO SC2	3275.00	847.35	857.54		858.04	0.001673	6.25	669.21	178.33	0.37
STREAM CENTERLIN	456.22	100 yr	EX	3275.00	847.35	857.35		857.91	0.001869	6.55	635.58	172.41	0.39
STREAM CENTERLIN	391.61	100 yr	PRO SC1	3275.00	848.88	857.70		858.10	0.001739	5.80	707.53	184.82	0.37
STREAM CENTERLIN	391.61	100 yr	PRO SC2	3275.00	848.88	857.44		857.80	0.002097	6.23	660.39	180.23	0.40
STREAM CENTERLIN	391.61	100 yr	EX	3275.00	848.88	857.22		857.75	0.002471	6.83	621.41	176.52	0.43
STREAM CENTERLIN	346.89	100 yr	PRO SC1	3275.00	849.55	857.65	855.78	858.01	0.001857	5.21	701.54	183.08	0.37
STREAM CENTERLIN	346.89	100 yr	PRO SC2	3275.00	849.55	857.38		857.80	0.002290	5.62	652.58	178.12	0.41
STREAM CENTERLIN	346.89	100 yr	EX	3275.00	849.55	857.15	855.78	857.63	0.002768	6.01	611.21	175.71	0.44
STREAM CENTERLIN	314			Bridge									
STREAM CENTERLIN	291.28	100 yr	PRO SC1	3275.00	849.49	857.33	855.65	857.69	0.001825	5.34	717.59	207.13	0.37
STREAM CENTERLIN	291.28	100 yr	PRO SC2	3275.00	849.49	857.33	855.65	857.69	0.001825	5.34	717.59	207.13	0.37
STREAM CENTERLIN	291.28	100 yr	EX	3275.00	849.49	855.85	855.65	856.88	0.008800	9.54	398.31	165.34	0.78
STREAM CENTERLIN	278			Bridge									
STREAM CENTERLIN	215.19	100 yr	PRO SC1	3275.00	846.40	855.59		855.95	0.002226	5.05	716.30	230.93	0.40
STREAM CENTERLIN	215.19	100 yr	PRO SC2	3275.00	846.40	855.59		855.95	0.002226	5.05	716.30	230.93	0.40
STREAM CENTERLIN	215.19	100 yr	EX	3275.00	846.40	855.56		855.94	0.002248	5.08	713.61	230.53	0.40
STREAM CENTERLIN	158.29	100 yr	PRO SC1	3275.00	846.25	855.37	854.32	855.77	0.003578	5.47	669.43	269.73	0.47
STREAM CENTERLIN	158.29	100 yr	PRO SC2	3275.00	846.25	855.37	854.32	855.77	0.003578	5.47	669.43	269.73	0.47
STREAM CENTERLIN	158.29	100 yr	EX	3275.00	846.25	855.37	854.32	855.77	0.003578	5.47	669.43	269.73	0.47
STREAM CENTERLIN	95.99	100 yr	PRO SC1	3275.00	846.17	854.28	854.28	855.32	0.014646	8.26	411.28	221.39	0.88
STREAM CENTERLIN	95.99	100 yr	PRO SC2	3275.00	846.17	854.28	854.28	855.32	0.014646	8.26	411.28	221.39	0.88
STREAM CENTERLIN	95.99	100 yr	EX	3275.00	846.17	854.28	854.28	855.32	0.014646	8.26	411.28	221.39	0.88

Tie Into Susie Jane Plan: 1) PRO 2BRDG 7/7/2014 2) PRO WO EGBRDG 7/7/2014 3) EG BRDG 7/7/2014

Geom: Existing Conditions Flow: stream flow data  
 River = Buckeye Creek Reach = STREAM CENTERLIN RS = 95.99

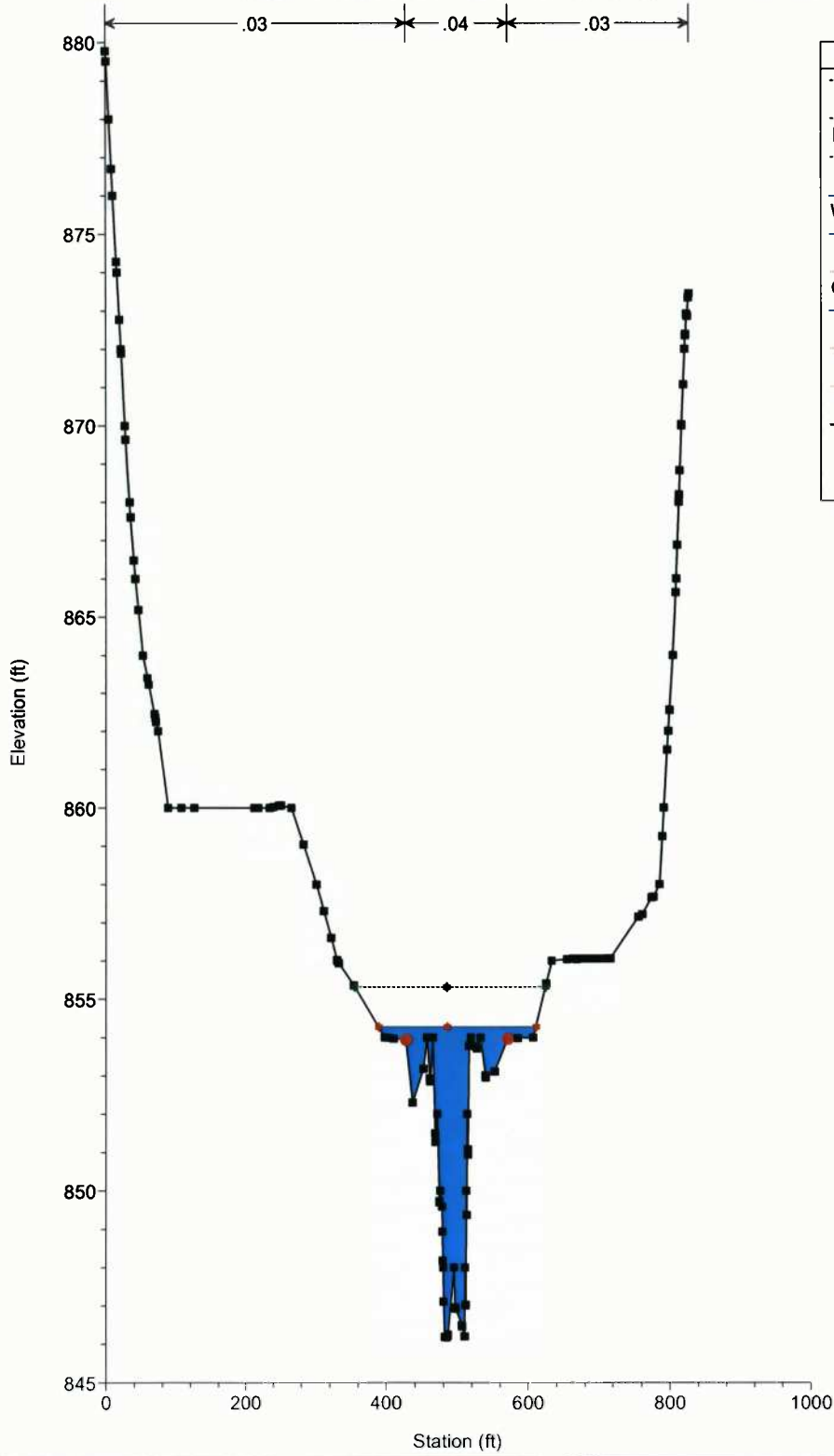

Legend	
EG 100 yr - PRO 2BRDG	▲
EG 100 yr - PRO WO EGBRDG	◆
EG 100 yr - EG BRDG	●
WS 100 yr - PRO WO EGBRDG	◆
WS 100 yr - PRO 2BRDG	▲
Crit 100 yr - PRO WO EGBRDG	◆
WS 100 yr - EG BRDG	◆
Crit 100 yr - PRO 2BRDG	▲
Crit 100 yr - EG BRDG	●
Ground	■
Bank Sta	●







Tie Into Susie Jane Plan: 1) PRO 2BRDG 7/7/2014 2) PRO WO EGBRDG 7/7/2014 3) EG BRDG 7/7/2014

Geom: Existing Conditions Flow: stream flow data

River = Buckeye Creek Reach = STREAM CENTERLIN RS = 799.35

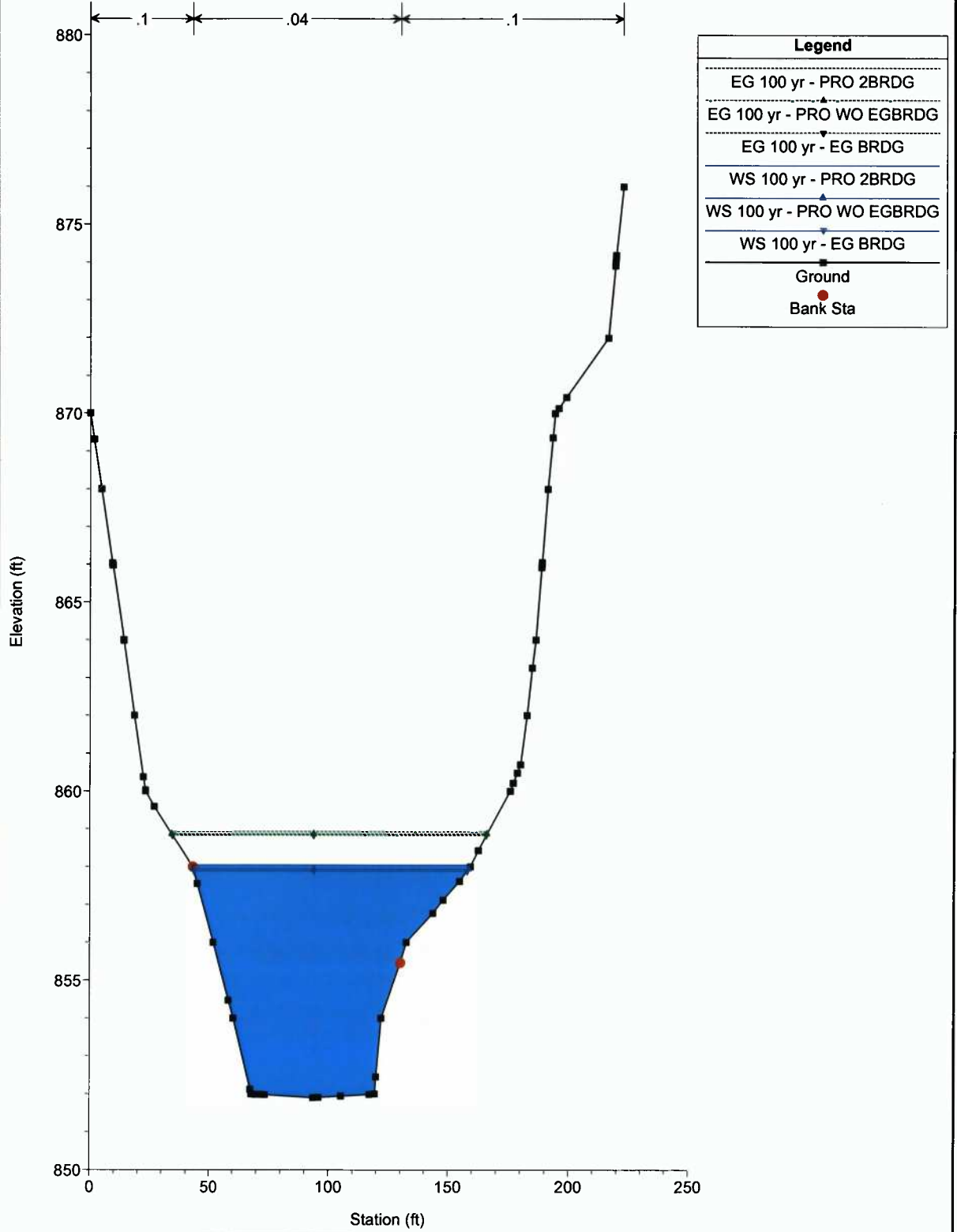

Tie Into Susie Jane Plan: 1) PRO 2BRDG 7/7/2014 2) PRO WO EGBRDG 7/7/2014 3) EG BRDG 7/7/2014

Geom: Existing Conditions Flow: stream flow data

River = Buckeye Creek Reach = STREAM CENTERLIN RS = 712.95

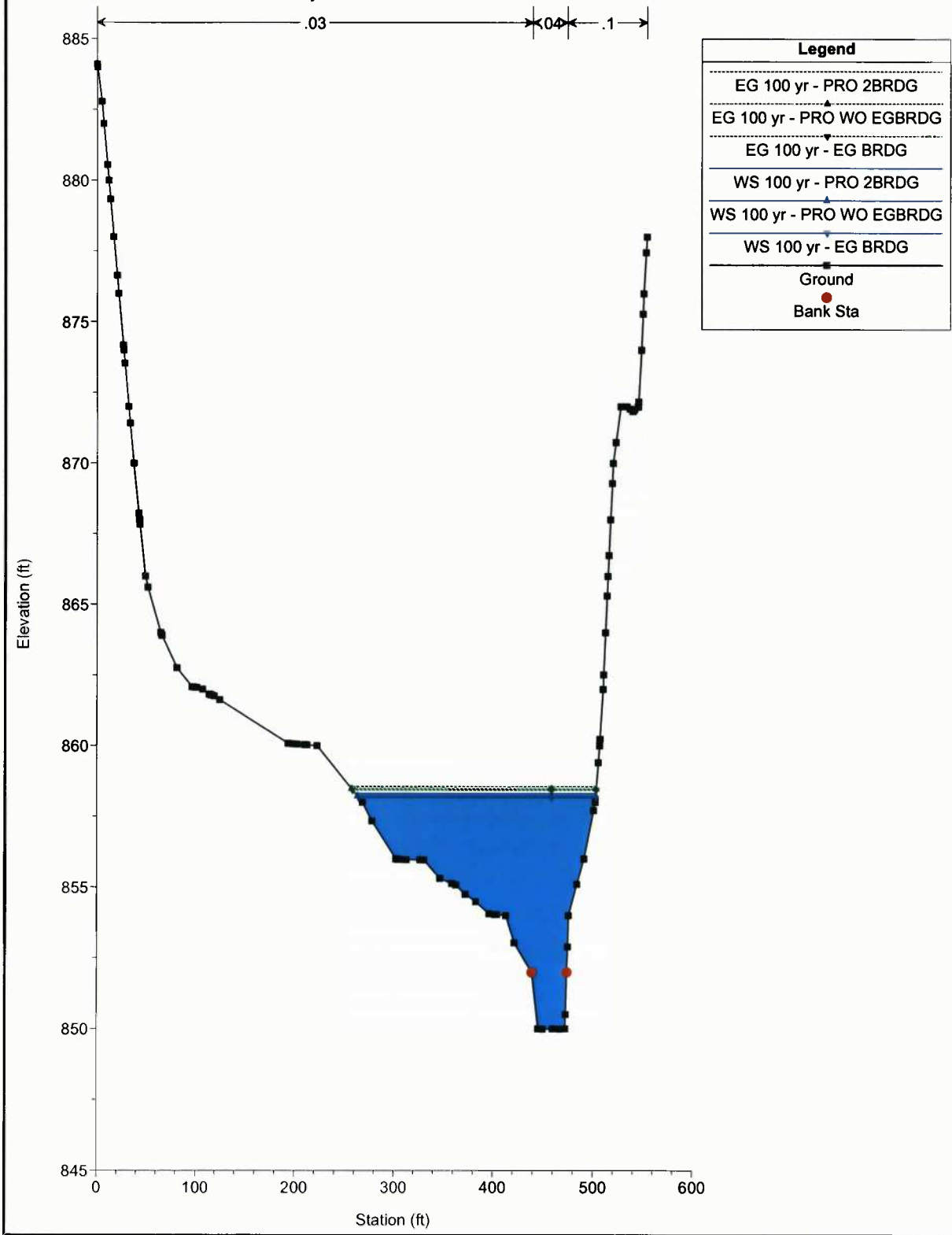

Tie Into Susie Jane Plan: 1) PRO 2BRDG 7/7/2014 2) PRO WO EGBRDG 7/7/2014 3) EG BRDG 7/7/2014

Geom: Existing Conditions Flow: stream flow data  
River = Buckeye Creek Reach = STREAM CENTERLIN RS = 639.43

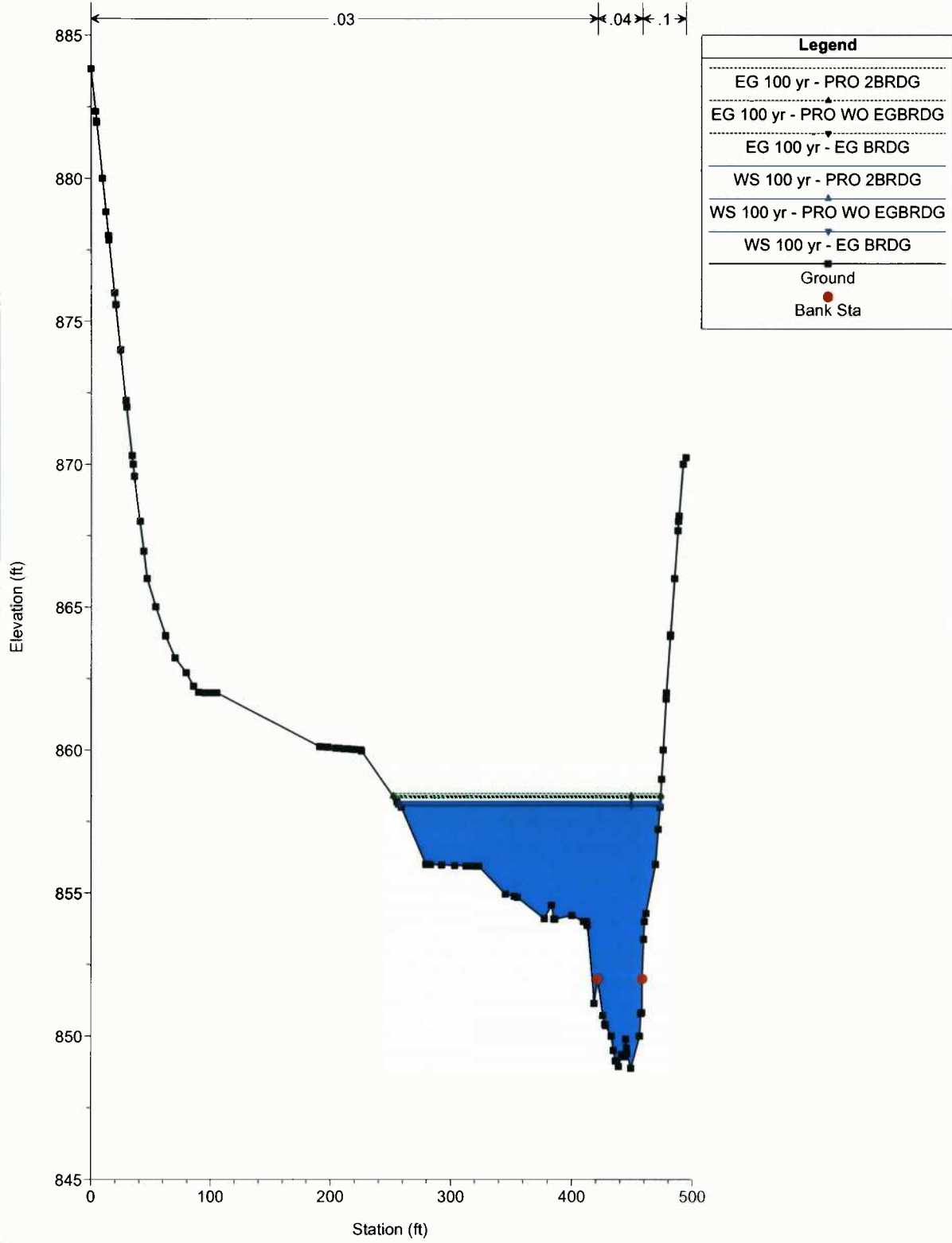

Tie Into Susie Jane Plan: 1) PRO 2BRDG 7/7/2014 2) PRO WO EGBRDG 7/7/2014 3) EG BRDG 7/7/2014

Geom: Existing Conditions Flow: stream flow data  
River = Buckeye Creek Reach = STREAM CENTERLIN RS = 577.85

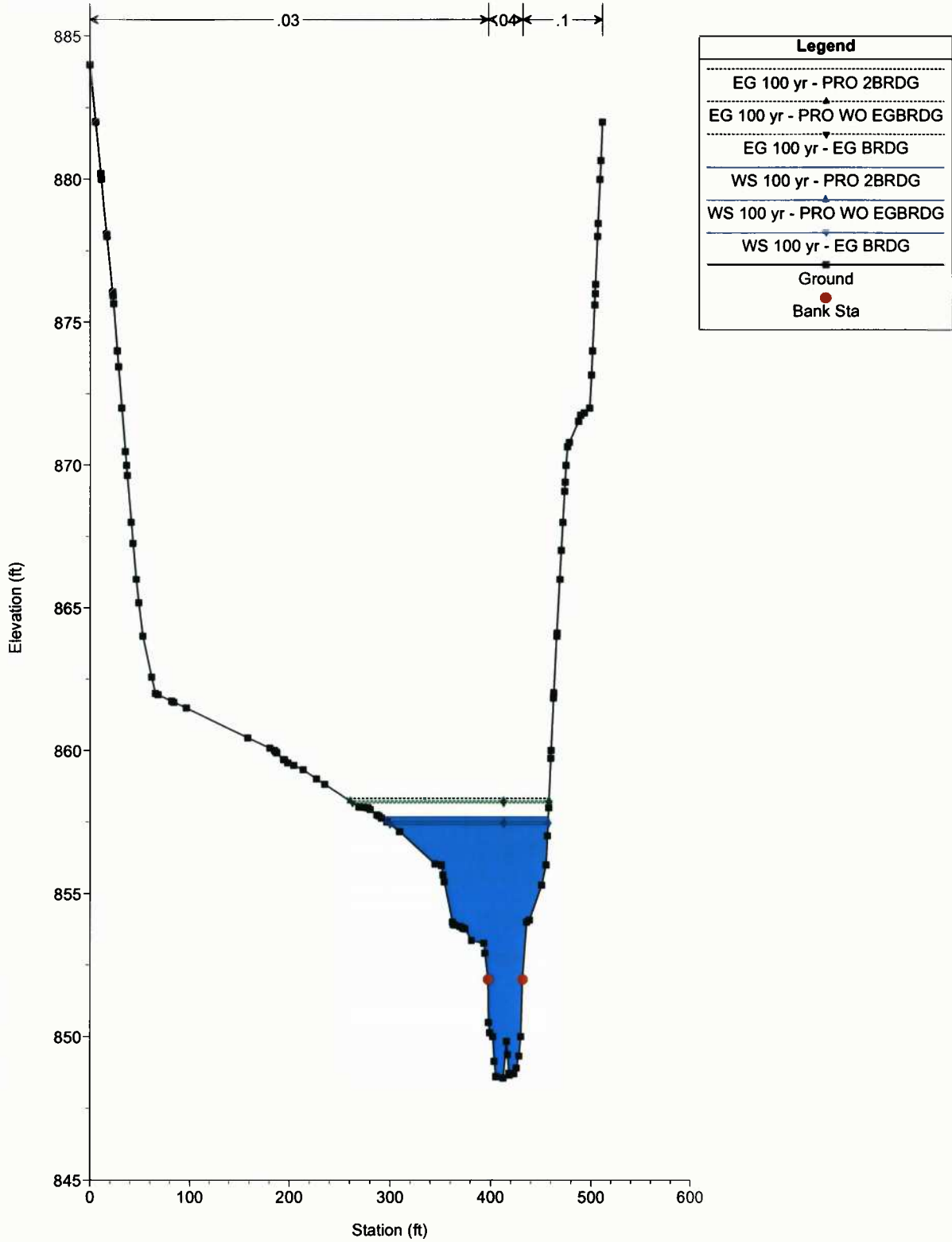

Tie Into Susie Jane Plan: 1) PRO 2BRDG 7/7/2014 2) PRO WO EGBRDG 7/7/2014 3) EG BRDG 7/7/2014

Geom: Existing Conditions Flow: stream flow data  
River = Buckeye Creek Reach = STREAM CENTERLIN RS = 517.66

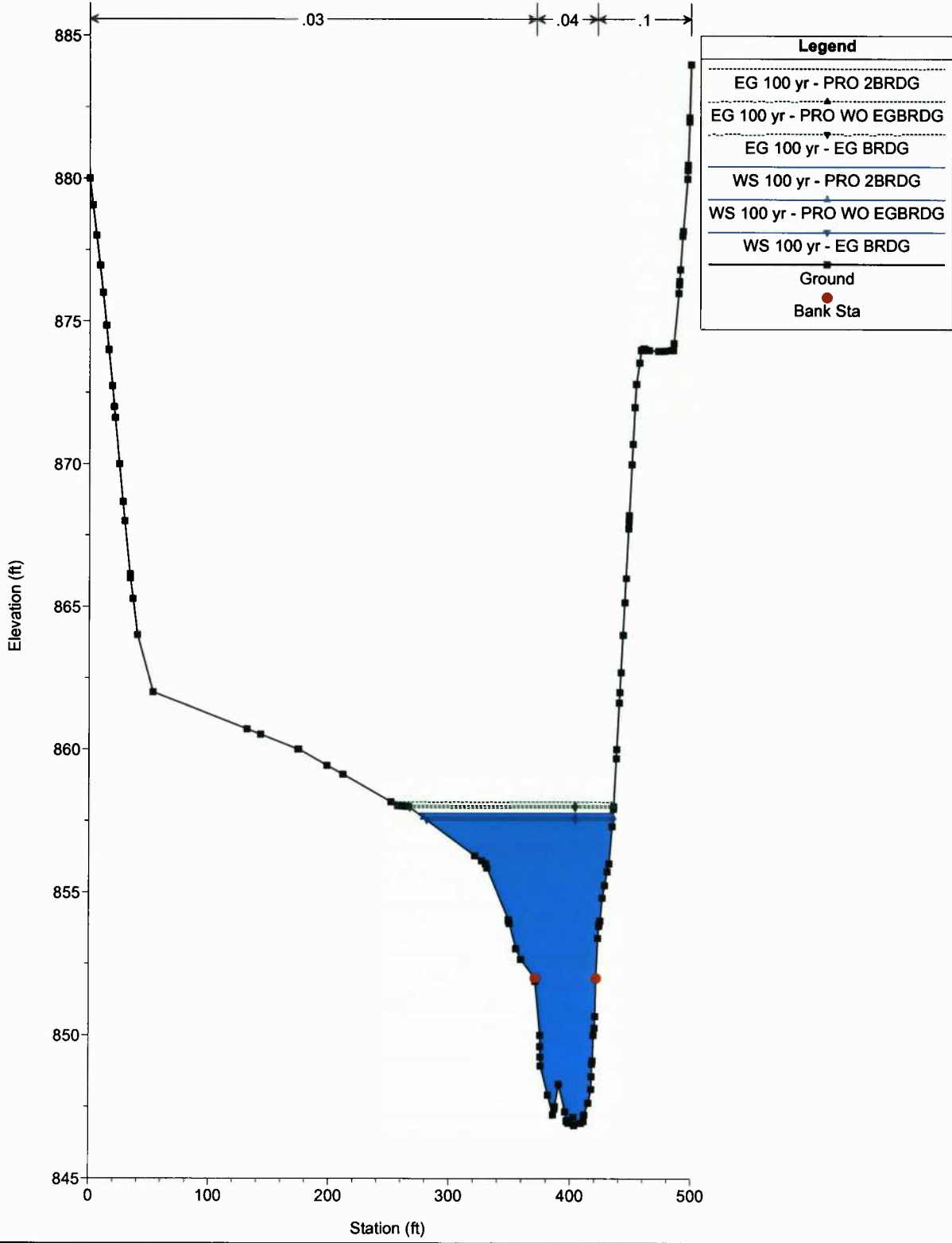

Tie Into Susie Jane Plan: 1) PRO 2BRDG 7/7/2014 2) PRO WO EGBRDG 7/7/2014 3) EG BRDG 7/7/2014

Geom: Existing Conditions Flow: stream flow data  
River = Buckeye Creek Reach = STREAM CENTERLIN RS = 456.22

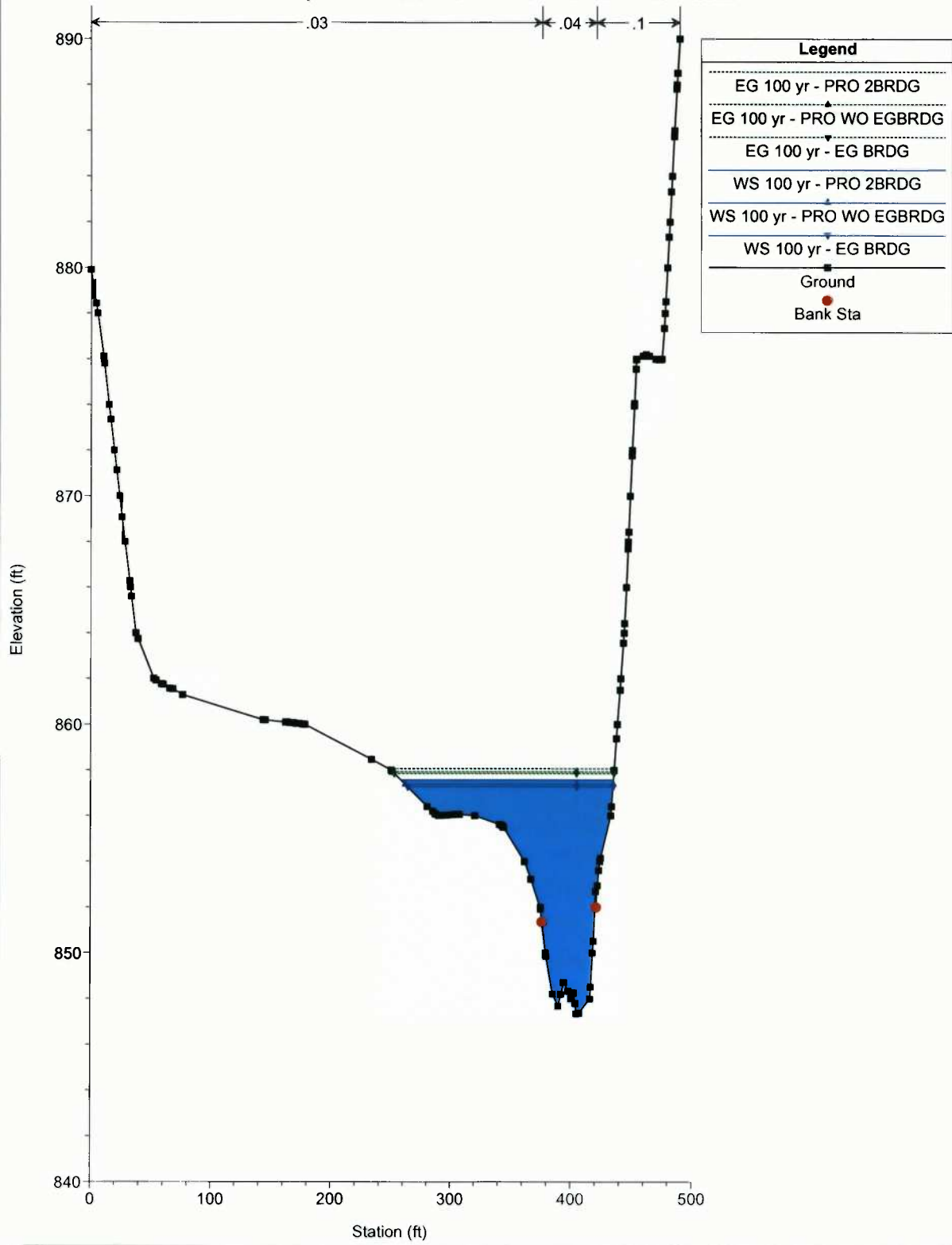

Tie Into Susie Jane Plan: 1) PRO 2BRDG 7/7/2014 2) PRO WO EGBRDG 7/7/2014 3) EG BRDG 7/7/2014

Geom: Existing Conditions Flow: stream flow data

River = Buckeye Creek Reach = STREAM CENTERLIN RS = 391.61

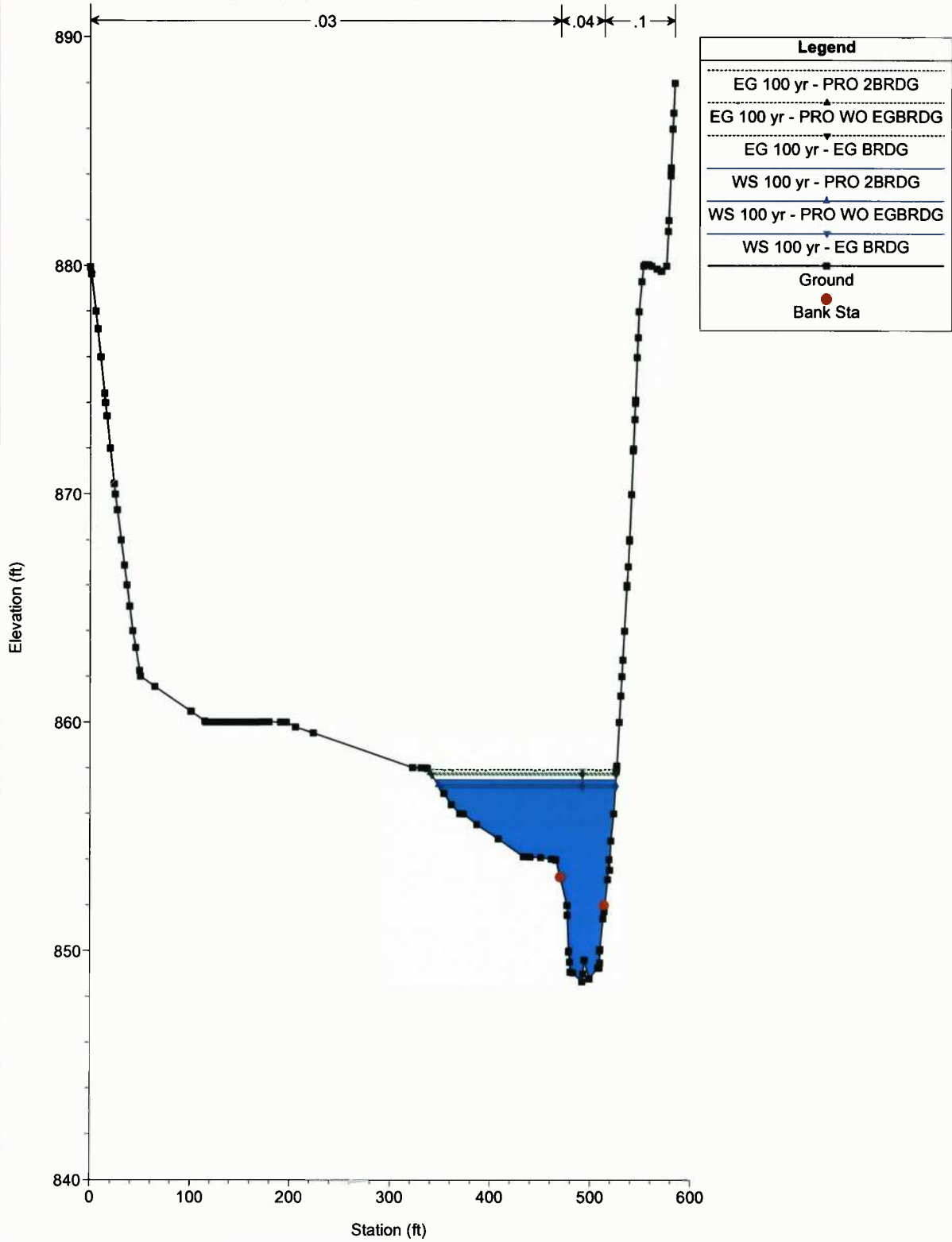

Tie Into Susie Jane Plan: 1) PRO 2BRDG 7/7/2014 2) PRO WO EGBRDG 7/7/2014 3) EG BRDG 7/7/2014

Geom: Existing Conditions Flow: stream flow data

River = Buckeye Creek Reach = STREAM CENTERLIN RS = 346.69

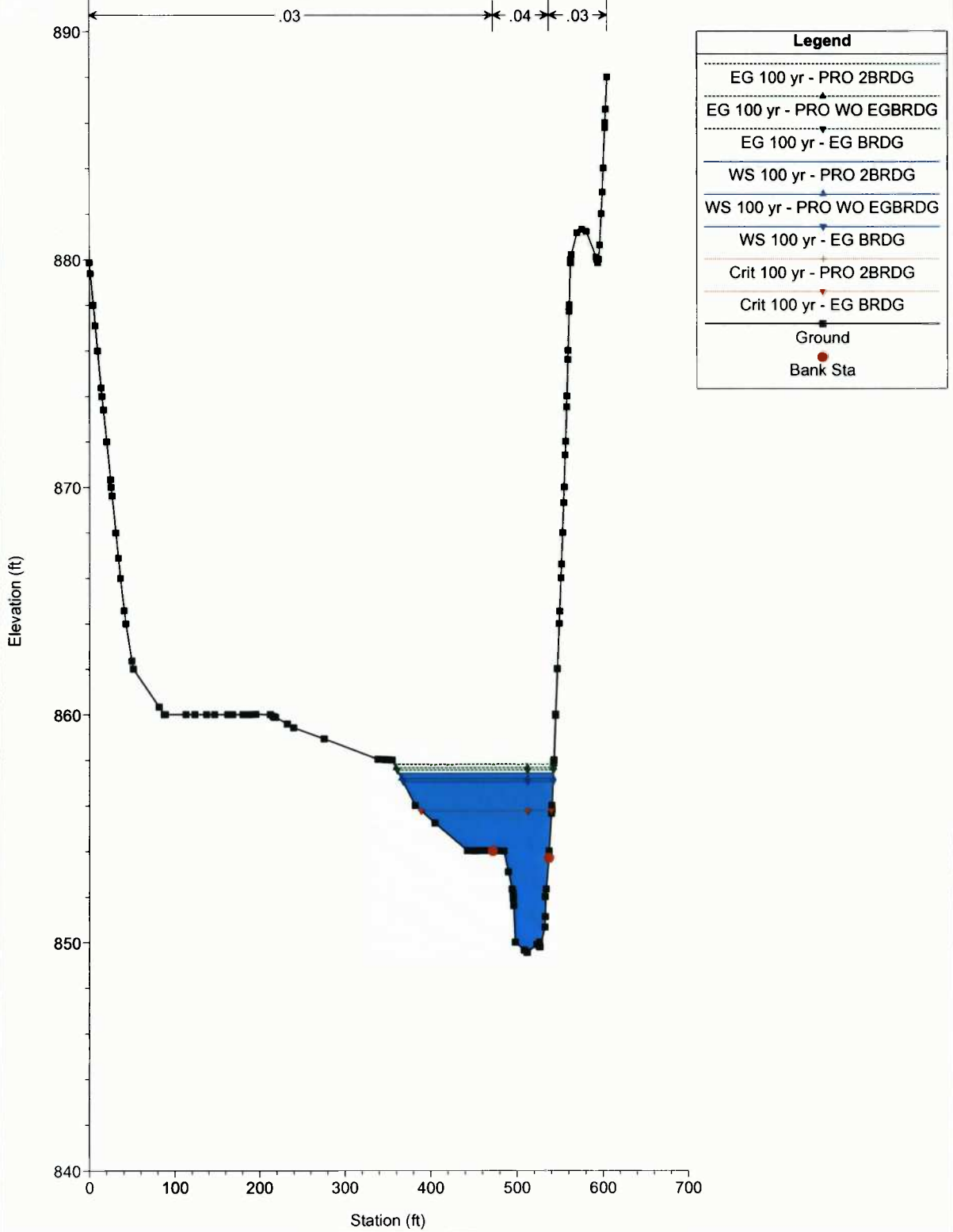



Tie Into Susie Jane Plan: 1) PRO 2BRDG 7/7/2014 2) PRO WO EGBRDG 7/7/2014 3) EG BRDG 7/7/2014

Geom: Existing Conditions Flow: stream flow data  
River = Buckeye Creek Reach = STREAM CENTERLIN RS = 314 BR

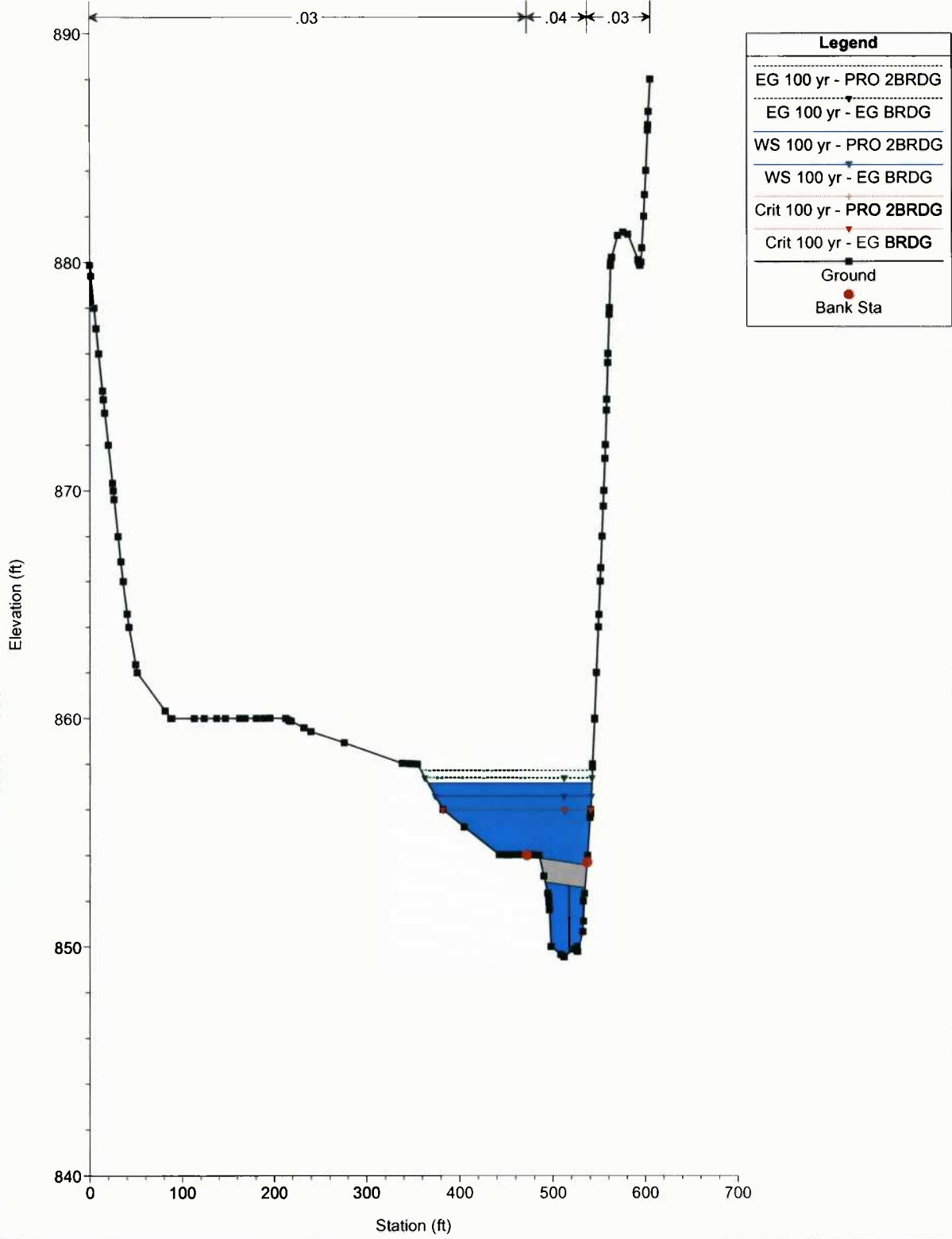





Tie-In  
 LOD  
 LOD: 11.48 Acres  
 Quad: Smithburg  
 1 inch = 500 feet

By: egraser

Copyright: © 2013 National Geographic Society, i-cubed

THRASHER

Figure 1: Site Location  
Tie-in to Susie Jane  
Doddridge County - West Virginia

5/22/2014





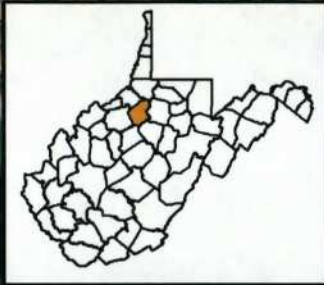

NWI  
LOD  
1 inch = 500 feet

Note: NWI data is downloaded from the US Fish & Wildlife website and used without any edits or modifications

Source: Esri, DigitalGlobe, GeoEye, i-cubed, USDA, USGS, AEX, Getmapping, Aerogrid, IGN, IGP, swisstopo, and the GIS User Community

THRASHER

Figure 2: NWI Mapper  
Tie-in to Susie Jane  
Doddridge County - West Virginia



5/22/2014





THRASHER

5/22/2014

Figure 3: Soil Types

Tie-in to Susie Jane

Doddridge County - West Virginia



Source: Esri, DigitalGlobe, GeoEye, i-cubed, USDA, USGS, AEX, Getmapping, Aerogrid, IGN, IGP, swisstopo, and the GIS User Community

By: egraser





- |                |                   |
|----------------|-------------------|
| Streams        | ● OHWM            |
| — Ephemeral    | ★ Tie-In          |
| — Intermittent | — Pipeline        |
| — Perennial    | ▨ Workspace       |
| Wetland        | ▭ Access Road     |
| ▨ PEM          | ▭ LOD             |
| ▨ POW          | 1 inch = 500 feet |

THRASHER

Figure 4: Delineation  
Tie-in to Susie Jane  
Dodridge County - West Virginia

5/22/2014



Copyright © 2013 National Geographic Society, i-cubed





Drive 10.2 mi, 17 min

Directions from Court St to Sherwood-Greenbrier Rd



**O** Court St

West Union, WV 26456

Take WV-18 S to US-50 E

0.8 mi / 3 min

- ↑** 1. Head northeast on Columbia St toward W Main St  
269 ft
- ↗** 2. Take the 2nd right onto E Main St  
0.2 mi
- ↘** 3. Turn right onto WV-18 S  
0.5 mi

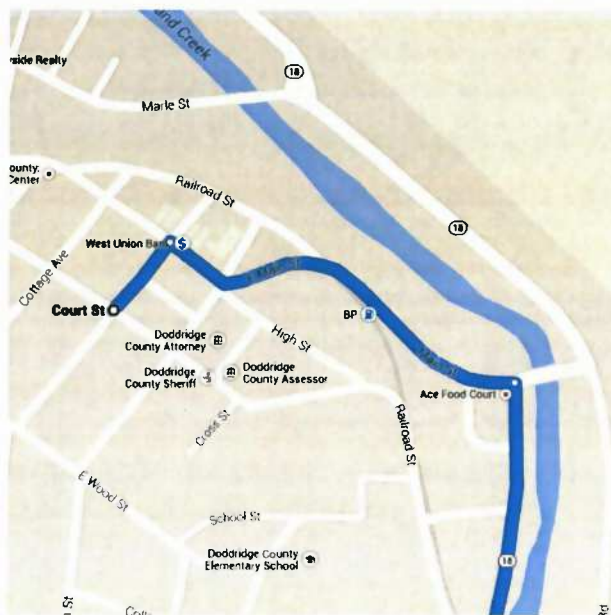

Turn left onto US-50 E



5.6 mi / 6 min



Follow **Blacklick Rd** to your destination in Oak

3.7 mi / 8 min

- 5. Turn **right** at Co Rte 50/35  
 0.1 mi
- 6. Take the 1st **right** onto Co Rte 15/Blacklick Rd/Sherwood-Greenbrier Rd  

 Continue to follow Co Rte 15/Blacklick Rd  
 0.4 mi
- 7. Turn **left** onto Blacklick Rd/Long Run Rd/Sherwood-Greenbrier Rd  

 Continue to follow Blacklick Rd/Sherwood-Greenbrier Rd  
 1.6 mi
- 8. Turn **right** onto Co Rte 15/Blacklick Rd/Sherwood-Greenbrier Rd  
 1.5 mi
- 9. Turn **right**  

 Destination will be on the right  
 89 ft



**Sherwood-Greenbrier Rd**  
Oak, WV

These directions are for planning purposes only. You may find that construction projects, traffic, weather, or other events may cause conditions to differ from the map results, and you should plan your route accordingly. You must obey all signs or notices regarding your route.

Map data ©2014 Google

# THRASHER

May 13, 2014

U.S. Fish and Wildlife Service  
West Virginia Field Office  
694 Beverly Pike  
Elkins, WV 26241

RECEIVED  
MAY 14 2014  
WVFO

**RE: Project Review Request  
Crestwood Marcellus Midstream LLC  
Tie-In to Susie Jane Pipeline, Doddridge County, West Virginia  
Thrasher Project #101-070-0288**

To whom it may concern:

On behalf of Crestwood Marcellus Midstream LLC (Crestwood), The Thrasher Group, Inc. (Thrasher) is submitting to your office a project review request for a proposed linear pipeline project in the USGS Smithfield 7.5 minute quadrangle of Doddridge County, WV.

The proposed area of interest (AOI) for the Tie-In to Susie Jane Pipeline consists of a 75' wide right-of-way (ROW) which contains approximately 11.47 acres. The proposed 16" steel Tie-In to Susie Jane Pipeline originates at the Susie Jane Well Pad located at approximately 39.25416° N / 80.632602° W. From there it extends 5,700 linear feet northwest to a proposed above ground riser located in a 150' x 150' tie-in area at the coordinates; 39.257315° N / 80.650861° W. The proposed project will also involve expanding an existing access road and creating one (1) 50' x 300' and seven (7) 50' x 150' workspaces. An additional access road, which involves the installation of a 20' x 50' bridge over Buckeye Creek, will be constructed to facilitate access to the tie-in area.



## United States Department of the Interior

### FISH AND WILDLIFE SERVICE

West Virginia Field Office  
694 Beverly Pike  
Elkins, West Virginia 26241



In response to your letter above, we have made a "no effect" determination that the project will not affect federally-listed endangered or threatened species. Therefore no biological assessment or further section 7 consultation under the Endangered Species Act is required with the Fish and Wildlife Service. Should project plans change, or if additional information on listed and proposed species becomes available, this determination may be reconsidered.

Definitive determinations of the presence of waters of the United States, including wetlands, in the project area and the need for permits, if any, are made by the U.S. Army Corps of Engineers. They may be contacted at: Huntington District, Regulatory Branch, 502 Eighth Street, Huntington, West Virginia 25701, telephone (304) 399-5710.

*Tieran Lennon* 6/2/14  
Reviewer's signature and date

*Greg Schuler* 6/3/14  
Field Supervisor's signature and date





**DIVISION OF NATURAL RESOURCES**  
**Wildlife Resources Section**  
**Operations Center**  
**P.O. Box 67**  
**Elkins, West Virginia 26241-3235**  
**Telephone (304) 637-0245**  
**Fax (304) 637-0250**

**Earl Ray Tomblin**  
*Governor*

**Frank Jezioro**  
*Director*

June 4, 2014

Mr. Jordan P. Wilcox  
The Thrasher Group, Inc.  
PO Box 940  
Bridgeport, WV 26330

Dear Mr. Wilcox:

We have reviewed our files for information on rare, threatened and endangered (RTE) species and sensitive habitats for the area of the proposed Tie-In to Susie Jane Pipeline project in Doddridge County, WV (Project #101-070-0288).

We have no known records of any RTE species or sensitive habitats within the project area. The Wildlife Resources Section knows of no surveys that have been conducted in the area for rare species or rare species habitat. Consequently, this response is based on information currently available and should not be considered a comprehensive survey of the area under review.

The information provided above is the product of a database search and retrieval. This information does not satisfy other consultation or permitting requirements for disturbances to the natural resources of the state, and further consultation may be required.

Thank you for your inquiry, and should you have any questions please feel free to contact me at the above number, extension 2048. Enclosed please find an invoice.

Sincerely,

  
Barbara Sargent  
Environmental Resources Specialist  
Wildlife Diversity Unit

enclosure

S:\Monthly\Barb\Invoices\Thrasher2.doc



**DIVISION OF NATURAL RESOURCES**  
**Wildlife Resources Section**  
**Operations Center**  
**P.O. Box 67**  
**Elkins WV 26241**  
**Telephone (304) 637-0245 ext. 2039**  
**Fax (304) 637-0250**

**Earl Ray Tomblin**  
*Governor*

**Frank Jezioro**  
*Director*

June 23, 2014

Tyler Spear  
The Thrasher Group, Inc.  
PO Box 940  
Bridgeport, WV 26330

Subject: Kuhl Pipeline and the Tie-In to Susie Jane Pipeline, Buckeye Creek Stream Crossings, Doddridge County, WV

Dear Mr. Spear:

I have received and reviewed the mussel survey report for the above project on Buckeye Creek. No further mussel issues need to be addressed with respect to these three stream crossings for this project.

Should you have any questions, please feel free to contact me at the above address or phone number.

Sincerely,

Janet L. Clayton  
Wildlife Diversity Biologist  
Mussel Program

## Ryan S. Boustany

---

**From:** DEP NPDESEP <DEP.NPDESEP@wv.gov>  
**Sent:** Tuesday, July 01, 2014 5:27 PM  
**To:** DEP NPDESEP; dbutler@crestwoodlp.com  
**Cc:** Ryan S. Boustany; Minigh, Christina D  
**Subject:** Approval for WVR310298, Tie-In to Susie Jane Pipeline, Doddridge Co., 11.47 Acres

Don Butler, Director- ESR  
Crestwood Marcellus Midstream LLC  
801 Cherry St.  
Ste. 3800, Unit 20  
Fort Worth, TX 76102

Physical Site Location: Co. Rt. 15, New Milton

Please be advised that this e-mail constitutes approval for your project associated with Oil and Gas Construction Activities and your registration no. is WVR310298. You are now authorized to operate under WV General Water Pollution Control Permit No. WV0116815, issued on May 13, 2013.

You should carefully read the contents of this General Permit and become familiar with all requirements needed to remain in compliance with your permit. A "Notice of Termination" form is to be completed and submitted when all disturbed areas are stabilized. You can find the permit and Notice of Termination form via the Internet by visiting Permitting, Division of Water and Waste Management at [www.dep.wv.gov](http://www.dep.wv.gov).

Your annual permit fee has been assessed as \$500.00. You will be invoiced by this agency upon the anniversary date of this approval date. Failure to submit the annual fee within ninety (90) days of the due date will render your permit void upon the date you are mailed a certified written notice to that effect. Please be advised that a pro-rated annual permit fee may be assessed upon the completion date and proper stabilization.

If you have any questions relative to this approval, please do not hesitate to contact Joseph Cochran at (304) 926-0499 Ext. 1069 or by email at [joseph.w.cochran@wv.gov](mailto:joseph.w.cochran@wv.gov)

Scott G. Mandirola, Director  
WV DEP-Division of Water & Waste Mgt.  
601 57<sup>th</sup> St. SE  
Charleston, WV 25304-2345  
Phone: (304) 926-0495  
Fax: (304) 926-0496



DEPARTMENT OF THE ARMY  
HUNTINGTON DISTRICT, CORPS OF ENGINEERS  
602 EIGHTH STREET  
HUNTINGTON, WEST VIRGINIA 25701-2070

REPLY TO  
ATTENTION OF

JUL 24 2014

Regulatory Division  
Energy Resource Branch  
LRH-2014-00576-OHR Buckeye Creek  
Tie In to Susie Jane Pipeline

*Tie-In to  
Susie Jane*

Mr. Don Butler  
Crestwood Marcellus Midstream, LLC  
801 Cherry Street  
Suite 3400, Unit 20  
Fort Worth, Texas 76102

Dear Mr. Butler:

I refer to information received in this office on May 27, 2014, and subsequent information received June 23, 2014 and July 1, 2014 requesting Department of the Army (DA) authorization to discharge dredged and/or fill material into waters of the United States (U.S) as a part of the Tie In to Susie Jane Pipeline Project. On-site waters flow into Buckeye Creek. All of the waters on-site drain to Middle Island Creek, a traditionally navigable water (TNW) of the United States. The project will be located approximately 1.0 mile southeast of the community of Long Run at the tie-in area and proceeds generally east for 1.08 miles to the Susie Jane Pipeline. The project is located in Doddridge County, West Virginia. This project has been assigned the following file number: LRH-2014-00576-OHR, Buckeye Creek. Please reference this file number on all future correspondence related to this project.

The U.S. Army Corps of Engineers (Corps) authority to regulate waters of the U.S. is based, in part, on the definitions and limits of jurisdiction contained in 33 CFR 328 and 33 CFR 329. Section 404 of the Clean Water Act requires that a Department of the Army permit be obtained prior to the discharge of dredged or fill material into waters of the United States, including wetlands. Section 10 of the Rivers and Harbors Act of 1899 requires that a Department of the Army permit be obtained for any work in, on, over or under a navigable water.

The proposed project, as described in the submitted information, has been reviewed in accordance with Section 404 of the Clean Water Act and Section 10 of the Rivers and Harbors Act. Based on your description of the proposed work, and other information available to us, it has been determined that this project will not involve activities subject to the requirements of Section 10. However, this project will include the discharge of dredged or fill material into waters of the United States subject to the requirements of Section 404.

*Preliminary Jurisdictional Determination*

Based on a review of the information provided, and other information available to us, 10 streams and two wetlands are located within the delineation boundary as described in the enclosed table. This office has determined the streams and wetlands may be waters of the U.S. in accordance with the Regulatory Guidance Letter (RGL) for JDs issued by the Corps on June 26, 2008 (RGL No. 08-02). As indicated in the guidance, this preliminary JD is non-binding and cannot be appealed (33 CFR 331.2) and only provides a written indication that waters of the U.S., including wetlands, may be present on-site.

You have declined to exercise the option to obtain an approved JD in this instance and at this time. For the purposes of the determination of impacts, compensatory mitigation, and other resource protection measures for activities that require authorization from this office, the streams and wetlands described in the attached *Preliminary Jurisdictional Determination Form* will be evaluated as if they are waters of the U.S. Enclosed please find two copies of the preliminary JD. If you agree with the findings of this preliminary JD and understand your options regarding the same, please sign and date one copy of the form and return it to this office within 30 days of receipt of this letter. You should submit the signed copy to the following address:

Mr. Adam Fannin (LRH-2014-00576-OHR Buckeye Creek)  
U.S. Army Corps of Engineers, Huntington District  
502 Eight Street  
Huntington, West Virginia 25701

*Nationwide Permit No. 12*

In the PCN received in this office on May 27, 2014, you have requested DA authorization to temporarily discharge dredged and/or fill material into a total of nine linear feet of three streams associated with the pipeline installation, and approximately 120 linear feet of four streams and 0.018 acre of wetland associated with access road construction at seven single and complete permit areas associated with the Tie In to Susie Jane Pipeline Project. The discharge of dredged and/or fill material into waters of the U.S. will facilitate the construction of one 16-inch steel natural gas pipeline for a length of 1.08 miles. The information submitted indicates the streams which are temporarily affected by the pipeline installation will be restored to pre-construction conditions upon completion of the project. Additionally, you note that matting would be utilized for equipment crossings of streams and wetlands which are not crossed by access roads or the pipeline routes to avoid discharges into waters of the U.S.

Based on your description of the proposed work, and other information available to us, it has been determined the proposed discharge of dredged and/or fill material into waters of the U.S., for the construction of the Tie In to Susie Jane Pipeline Project meets the criteria for authorization under Nationwide Permit (NWP) #12 under the February 21, 2012 Federal Register, Notice of Reissuance of NWPs (77 FR 10184) provided you comply with all terms and conditions of the enclosed material. The West Virginia Department of Environmental Protection has issued 401 Water Quality Certification for this NWP. A copy of this NWP can be found on our website at <http://www.lrh.usace.army.mil/Missions/Regulatory.aspx>

Please be aware this nationwide permit authorization does not obviate the requirement to obtain other Federal, state or local authorizations required by law. A copy of this NWP and letter must be supplied to your project engineer responsible for construction activities. If you have any questions concerning the above, please contact Mr. Adam Fannin at (304) 399-6901 or by email at [Adam.E.Fannin@usace.army.mil](mailto:Adam.E.Fannin@usace.army.mil).

Sincerely,

A handwritten signature in black ink that reads "Richard Berkes". The signature is written in a cursive style with a large, stylized initial "R".

Richard Berkes  
Regulatory Project Manager  
Energy Resources Branch

Enclosures

**PRELIMINARY JURISDICTIONAL DETERMINATION FORM**

**BACKGROUND INFORMATION**

**A. REPORT COMPLETION DATE FOR PRELIMINARY JURISDICTIONAL DETERMINATION (JD):** July 15, 2014

**B. NAME AND ADDRESS OF PERSON REQUESTING PRELIMINARY JD:**  
Mr. Don Butler  
Crestwood Marcellus Midstream LLC  
801 Cherry Street  
Suite 3400, Unit 20  
Fort Worth, Texas 76102

**C. DISTRICT OFFICE, FILE NAME, AND NUMBER:** LRH-2014-576-OHR-  
Buckeye Creek; Tie-In to Susie Jane Pipeline Project

**D. PROJECT LOCATION(S) AND BACKGROUND INFORMATION:  
(USE THE ATTACHED TABLE TO DOCUMENT MULTIPLE WATERBODIES AT DIFFERENT SITES)**

State: WV County/parish/borough: Doddridge City: N/A  
Center coordinates of site (lat/long in degree decimal format):  
Lat. 39.25562° E  
Long: 80.64164° W  
Name of nearest waterbody: Buckeye Creek

Identify (estimate) amount of waters in the review area:

Non-wetland waters: 7,774 linear feet: width: 1-85 (ft) and/or acres.  
Cowardin Class: Riverine  
Stream Flow: Perennial, Intermittent, Ephemeral  
Wetlands: 0.229 acres.  
Cowardin Class: Palustrine-Emergent  
Open Waters: 0.468 acres.  
Cowardin Class: Palustrine-Open Waters

Name of any water bodies on the site that have been identified as Section 10 waters:

Tidal: N/A

Non-Tidal: N/A

**E. REVIEW PERFORMED FOR SITE EVALUATION (CHECK ALL THAT APPLY):**

- Office (Desk) Determination. Date: July 15, 2014  
 Field Determination. Date(s):

**SUPPORTING DATA. Data reviewed for preliminary JD (check all that apply**

- checked items should be included in case file and, where checked and requested, appropriately reference sources below):

- Maps, plans, plots or plat submitted by or on behalf of the applicant/consultant:
- Data sheets prepared/submitted by or on behalf of the applicant/consultant.
  - Office concurs with data sheets/delineation report.
  - Office does not concur with data sheets/delineation report.
- Data sheets prepared by the Corps:
- Corps navigable waters' study:
- U.S. Geological Survey Hydrologic Atlas:
  - USGS NHD data.
  - USGS 8 and 12 digit HUC maps.
- U.S. Geological Survey map(s). Cite scale & quad name: 1:24k West Virginia-Smithburg
- USDA Natural Resources Conservation Service Soil Survey. Citation:.
- National wetlands inventory map(s). Cite name:
- State/Local wetland inventory map(s):
- FEMA/FIRM maps:
- 100-year Floodplain Elevation is: (National Geodectic Vertical Datum of 1929)
- Photographs:  Aerial (Name & Date):  
or  Other (Name & Date): Submitted in original application.
- Previous determination(s). File no. and date of response letter:
- Other information (please specify):

**IMPORTANT NOTE: The information recorded on this form has not necessarily been verified by the Corps and should not be relied upon for later jurisdictional determinations.**

 7/24/2014  
\_\_\_\_\_  
Signature and date of  
Regulatory Project Manager  
(REQUIRED)

\_\_\_\_\_  
Signature and date of  
person requesting preliminary JD  
(REQUIRED, unless obtaining  
the signature is impracticable)

See attached table and maps with Regulatory Project Manager's initials or signature.



AFF  
7/24/2014



THRASHER

Figure 4: Delineation  
Tie-in to Susie Jane  
Doddridge County - West Virginia



5/22/2014

Copyright © 2013 National Geographic Society, Inc.

RD-E-AEF

Permit Number: LRH-2014-00576-OHR-Buckeye Creek  
Tie In to Susie Jane Pipeline

Name of Permittee: Mr. Don Butler  
Crestwood Marcellus Midstream, LLC  
801 Cherry Street  
Suite 3400, Unit 20  
Fort Worth, Texas 76102

Date of Issuance: 7/22/2014

Upon completion of the activity authorized by this permit and any mitigation required by the permit, sign this certification and return it to the following address:

Huntington District  
U.S. Army Corps of Engineers  
502 8<sup>th</sup> Street  
Huntington, West Virginia 25701-2070  
Attn: RD-E

Please note that your permitted activity is subject to a compliance inspection by an United States Army Corps of Engineers representative. If you fail to comply with this permit you are subject to permit suspension, modification, or revocation.

I hereby certify that the work authorized by the above referenced permit has been completed in accordance with the terms and conditions of the said permit, and required mitigation was completed in accordance with the permit conditions.

\_\_\_\_\_  
Signature of Permittee

\_\_\_\_\_  
Date

## **Ryan S. Boustany**

---

**From:** DEP NPDESEP <DEP.NPDESEP@wv.gov>  
**Sent:** Tuesday, July 01, 2014 5:27 PM  
**To:** DEP NPDESEP; dbutler@crestwoodlp.com  
**Cc:** Ryan S. Boustany; Minigh, Christina D  
**Subject:** Approval for WVR310298, Tie-In to Susie Jane Pipeline, Doddridge Co., 11.47 Acres

Don Butler, Director- ESR  
Crestwood Marcellus Midstream LLC  
801 Cherry St.  
Ste. 3800, Unit 20  
Fort Worth, TX 76102

Physical Site Location: Co. Rt. 15, New Milton

Please be advised that this e-mail constitutes approval for your project associated with Oil and Gas Construction Activities and your registration no. is WVR310298. You are now authorized to operate under WV General Water Pollution Control Permit No. WV0116815, issued on May 13, 2013.

You should carefully read the contents of this General Permit and become familiar with all requirements needed to remain in compliance with your permit. A "Notice of Termination" form is to be completed and submitted when all disturbed areas are stabilized. You can find the permit and Notice of Termination form via the Internet by visiting Permitting, Division of Water and Waste Management at [www.dep.wv.gov](http://www.dep.wv.gov).

Your annual permit fee has been assessed as \$500.00. You will be invoiced by this agency upon the anniversary date of this approval date. Failure to submit the annual fee within ninety (90) days of the due date will render your permit void upon the date you are mailed a certified written notice to that effect. Please be advised that a pro-rated annual permit fee may be assessed upon the completion date and proper stabilization.

If you have any questions relative to this approval, please do not hesitate to contact Joseph Cochran at (304) 926-0499 Ext. 1069 or by email at [joseph.w.cochran@wv.gov](mailto:joseph.w.cochran@wv.gov)

Scott G. Mandirola, Director  
WV DEP-Division of Water & Waste Mgt.  
601 57<sup>th</sup> St. SE  
Charleston, WV 25304-2345  
Phone: (304) 926-0495  
Fax: (304) 926-0496



**DIVISION OF NATURAL RESOURCES**

**Wildlife Resources Section  
Operations Center  
P.O. Box 67  
Elkins, West Virginia 26241-3235  
Telephone (304) 637-0245  
Fax (304) 637-0250**

**Earl Ray Tomblin  
Governor**

**Frank Jezioro  
Director**

June 4, 2014

Mr. Jordan P. Wilcox  
The Thrasher Group, Inc.  
PO Box 940  
Bridgeport, WV 26330

Dear Mr. Wilcox:

We have reviewed our files for information on rare, threatened and endangered (RTE) species and sensitive habitats for the area of the proposed Tie-In to Susie Jane Pipeline project in Doddridge County, WV (Project #101-070-0288).

We have no known records of any RTE species or sensitive habitats within the project area. The Wildlife Resources Section knows of no surveys that have been conducted in the area for rare species or rare species habitat. Consequently, this response is based on information currently available and should not be considered a comprehensive survey of the area under review.

The information provided above is the product of a database search and retrieval. This information does not satisfy other consultation or permitting requirements for disturbances to the natural resources of the state, and further consultation may be required.

Thank you for your inquiry, and should you have any questions please feel free to contact me at the above number, extension 2048. Enclosed please find an invoice.

Sincerely,

A handwritten signature in black ink, appearing to read "Barbara Sargent", is written over a faint, larger signature.

Barbara Sargent  
Environmental Resources Specialist  
Wildlife Diversity Unit

enclosure

S:\Monthly\Barb\Invoices\Thrasher2.doc



**The Culture Center**  
1900 Kanawha Blvd., E.  
Charleston, WV 25305-0300

**Randall Reid-Smith, Commissioner**

Phone 304.558.0220 • www.wvculture.org  
Fax 304.558.2779 • TDD 304.558.3562

EEO/AAE Employer

July 16, 2014

RECEIVED

Mr. Jordan Wilcox  
Environmental Scientist  
Thrasher  
600 White Oaks Blvd.  
PO Box 940  
Bridgeport, WV 26330

RE: Tie-In to Susie Jane Pipeline  
Crestwood Marcellus Midstream, LLC  
FR#: 14-727-DO-1

Dear Mr. Wilcox:

We have reviewed the above mentioned project to determine its effects to cultural resources. As required by Section 106 of the National Historic Preservation Act of 1966, as amended, and its implementing regulations, 36 CFR 800: "Protection of Historic Properties," we submit our comments.

According to the submitted information, Crestwood Marcellus Midstream, LLC is altering the previously submitted plans by replacing the originally proposed above ground riser in the tie-in area with an underground valve. It is our understanding that no permanent above ground components will be constructed as part of this project. With this understanding, we have determined that no historic architectural properties are present within the Area of Potential Effect (APE). No further consultation is necessary regarding architectural resources; however, we ask that you contact our office if your project should change.

We appreciate the opportunity to be of service. *If you have questions regarding our comments or the Section 106 process, please contact Ernest Blevins, Structural Historian, at (304) 558-0240.*

Sincerely,

  
Susan M. Pierce

Deputy State Historic Preservation Officer

 SMP/EEB

# THRASHER

May 13, 2014

U.S. Fish and Wildlife Service  
West Virginia Field Office  
694 Beverly Pike  
Elkins, WV 26241

RECEIVED  
MAY 14 2014  
WVFO

**RE: Project Review Request  
Crestwood Marcellus Midstream LLC  
Tie-In to Susie Jane Pipeline, Doddridge County, West Virginia  
Thrasher Project #101-070-0288**

To whom it may concern:

On behalf of Crestwood Marcellus Midstream LLC (Crestwood), The Thrasher Group, Inc. (Thrasher) is submitting to your office a project review request for a proposed linear pipeline project in the USGS Smithfield 7.5 minute quadrangle of Doddridge County, WV.

The proposed area of interest (AOI) for the Tie-In to Susie Jane Pipeline consists of a 75' wide right-of-way (ROW) which contains approximately 11.47 acres. The proposed 16" steel Tie-In to Susie Jane Pipeline originates at the Susie Jane Well Pad located at approximately 39.25416° N / 80.632602° W. From there it extends 5,700 linear feet northwest to a proposed above ground riser located in a 150' x 150' tie-in area at the coordinates; 39.257315° N / 80.650861° W. The proposed project will also involve expanding an existing access road and creating one (1) 50' x 300' and seven (7) 50' x 150' workspaces. An additional access road, which involves the installation of a 20' x 50' bridge over Buckeye Creek, will be constructed to facilitate access to the tie-in area.



## United States Department of the Interior

### FISH AND WILDLIFE SERVICE

West Virginia Field Office  
694 Beverly Pike  
Elkins, West Virginia 26241



In response to your letter above, we have made a "no effect" determination that the project will not affect federally-listed endangered or threatened species. Therefore no biological assessment or further section 7 consultation under the Endangered Species Act is required with the Fish and Wildlife Service. Should project plans change, or if additional information on listed and proposed species becomes available, this determination may be reconsidered.

Definitive determinations of the presence of waters of the United States, including wetlands, in the project area and the need for permits, if any, are made by the U.S. Army Corps of Engineers. They may be contacted at: Huntington District, Regulatory Branch, 502 Eighth Street, Huntington, West Virginia 25701, telephone (304) 399-5710.

*Tieman Lennon* 6/2/14  
Reviewer's signature and date

*Greg Schuler* 6/3/14  
Field Supervisor's signature and date



STATE OF WEST VIRGINIA,  
COUNTY OF DODDRIDGE, TO WIT

I, Virginia Nicholson, Editor of THE  
HERALD RECORD, a weekly newspaper  
published regularly, in Doddridge County,  
West Virginia, Do Hereby Certify  
That the Accompanying Legal Notice  
Entitled:

*Floodplain Permit*  
*Tie-in to Susie Jane*  
*Pipeline # 14-247*

was published in said paper for *2*

successive weeks beginning with the issue  
of *August 5<sup>th</sup>* 2014 and  
ending with the issue of

*August 12<sup>th</sup>* 2014 and

that said notice contains *189*

WORD SPACE at *115* cents a word

amounts to the sum of \$ *21.74*

FOR FIRST PUBLICATION, SECOND  
PUBLICATION IS 75% OF THE FIRST  
PUBLICATION

\$ *16.31*

and each publication thereafter

\$ *38.05* TOTAL

EDITOR

*Virginia Nicholson*

SWORN TO AND SUBSCRIBED

BEFORE ME THIS THE *14<sup>th</sup>* DAY

OF *August* 2014

NOTARY PUBLIC

*Laura Adams*

**Legal Advertisement**

LEGAL ADVERTISEMENT  
Doddridge County  
Floodplain Permit Application  
Please take notice that on the 18th day of July, 2014  
Crestwood Marcellus Midstream LLC filed an  
application for a Floodplain Permit to develop land  
located at or about 39 25416N 80 631602 AWE to  
39 257215N / 80 650686W Permit #14-247 Tie-In to Susie  
Jane Pipeline  
The Application is on file with the Clerk of the County  
Court and may be inspected or copied during regular  
business hours. Any interested persons who desire to  
comment shall present the same in writing by August 27,  
2014.  
Delivered to the  
Clerk of the County Court  
118 E. Court Street, West Union, WV 26456  
Beth A. Rogers, Doddridge County Clerk  
Edwin L. "Bo" Wriston, Doddridge County Flood Plain  
Manager

